

# RIVETKING® FBS SERIES · STAINLESS/STEEL RIVETS · OPEN END

RIVET: 18-8 SERIES STAINLESS STEEL • MANDREL: STEEL TRIVALENT ZINC PLATED

RIVETKING® STAINLESS STEEL RIVET WITH STEEL ZINC PLATED MANDREL (FBS) SERIES IS THE ECONOMICAL ALTERNATIVE TO FBF SERIES. FBS Series offers similar shear and tensile strength and will hold its strength over time in corrosive environments. Because a steel mandrel has the potential to leave a rust trail, for aesthetic applications FBF series is recommended. IFI 114 Grade 50.

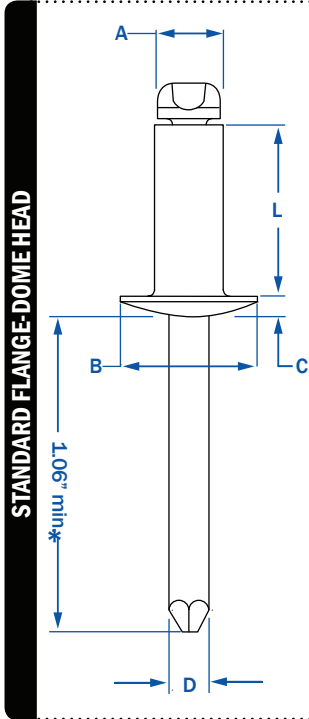

STANDARD FLANGE-DOME HEAD

DIA.	PART NUMBER	GRIP RANGE	RIVET LENGTH	HEAD DIA.	HEAD HEIGHT	MANDREL DIA.	HOLE SIZE (DRILL #)	STRENGTH		Wt. lbs/M
								SHEAR	TENSILE	
3/32"	FBS - 32	.020 - .125	.250	.188	.032	.057	.097 - .100 (#41)	230	280	
	FBS - 34	.126 - .250	.375							
	FBS - 41	.020 - .062	.212							
1/8"	FBS - 42	.063 - .125	.275	.250	.040	.076	.129 - .133 (#30)	420	530	2.60
	FBS - 43	.126 - .187	.337							3.00
	FBS - 44	.188 - .250	.400							3.10
	FBS - 45	.251 - .312	.462							3.20
	FBS - 46	.313 - .375	.525							3.60
	FBS - 48	.376 - .500	.650							3.50
5/32"	FBS - 52	.020 - .125	.300	.312	.050	.095	.160 - .164 (#20)	650	820	5.00
	FBS - 53	.126 - .187	.362							5.25
	FBS - 54	.188 - .250	.425							5.80
	FBS - 56	.251 - .375	.550							
	FBS - 58	.376 - .500	.675							
3/16"	FBS - 510	.501 - .625	.800	.375	.060	.114	.192 - .196 (#11)	950	1200	7.40
	FBS - 62	.063 - .125	.325							8.40
	FBS - 63	.126 - .187	.387							8.80
	FBS - 64	.188 - .250	.450							9.75
	FBS - 66	.251 - .375	.575							11.00
	FBS - 68	.376 - .500	.700							11.75
	FBS - 610	.501 - .625	.825							
	FBS - 612	.626 - .750	.950							
1/4"	FBS - 614	.751 - .875	1.075	.500	.080	.151	.257 - .261 (F)	1700	2100	
	FBS - 84	.063 - .125	.500							
	FBS - 86	.251 - .375	.625							
	FBS - 810	.501 - .625	.875							
	FBS - 812	.626 - .750	1.000							

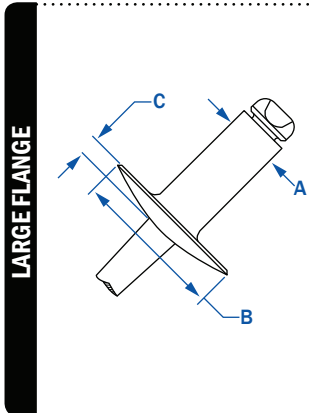

LARGE FLANGE

1/8"	FBS - 42LF	.020 - .125	.275	.375	.065	.076	.129 - .133 (#30)	420	530	3.30
	FBS - 43LF	.126 - .187	.337							3.50
	FBS - 44LF	.188 - .250	.375							3.60
	FBS - 45LF	.251 - .312	.462							
	FBS - 46LF	.313 - .375	.525							
5/32"	FBS - 52LF	.020 - .125	.300	.468	.075	.095	.160 - .164 (#20)	650	820	
	FBS - 53LF	.126 - .187	.362							
	FBS - 54LF	.188 - .250	.425							
	FBS - 56LF	.251 - .375	.550							
3/16"	FBS - 58LF	.376 - .500	.675	.625	.092	.114	.192 - .196 (#11)	950	1200	
	FBS - 62LF	.063 - .125	.375							10.67
	FBS - 64LF	.126 - .187	.450							11.33
	FBS - 66LF	.251 - .375	.575							11.67
	FBS - 68LF	.376 - .500	.700							13.00
	FBS - 610LF	.501 - .625	.825							14.50

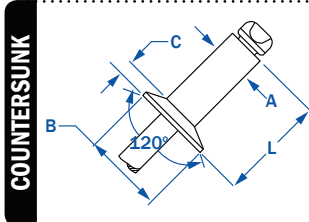

COUNTERSUNK

1/8"	FCS - 42	.063 - .125	.275	.220	.031	.076	.129 - .133 (#30)	420	530	3.00
	FCS - 43	.126 - .187	.337							3.10
	FCS - 44	.188 - .250	.400							3.30
5/32"	FCS - 54	.188 - .250	.425	.281	.040	.095	.160 - .164	650	820	5.36
3/16"	FCS - 64	.188 - .250	.450	.350	.050	.114	.192 - .196 (#11)	950	1200	7.60
	FCS - 66	.251 - .375	.575							9.79

\* 1/4" Diameter rivets have a 1.250 mandrel length minimum.

