

CLUFIX®

BLIND RIVET NUTS

Manufactured by Leankco Group



The **CLUFIX® rivet nut** is a branded product line made by LeankCo. **Rivet Nut USA™**, a division of Cardinal Components, Inc., is not a direct CLUFIX® distributor, but we can source and quote CLUFIX® products through a third-party.

Send us your CLUFIX® part number and we can assist!

Catalog found by Google search and provided by:

RIVET NUT USA™ | ISO 9001 CERTIFIED
RivetNutUSA.com | Sales@RivetNutUSA.com
800.236.3200

Écrous à sertir en aveugle Blind Rivet Nuts



Matière : Acier	Material : Steel
Tête : Affleurante	Head : Flush
Fût : Hexagonal	Body : Hexagonal
Extrémité du fût : Ouvert	Body end : Open Shape

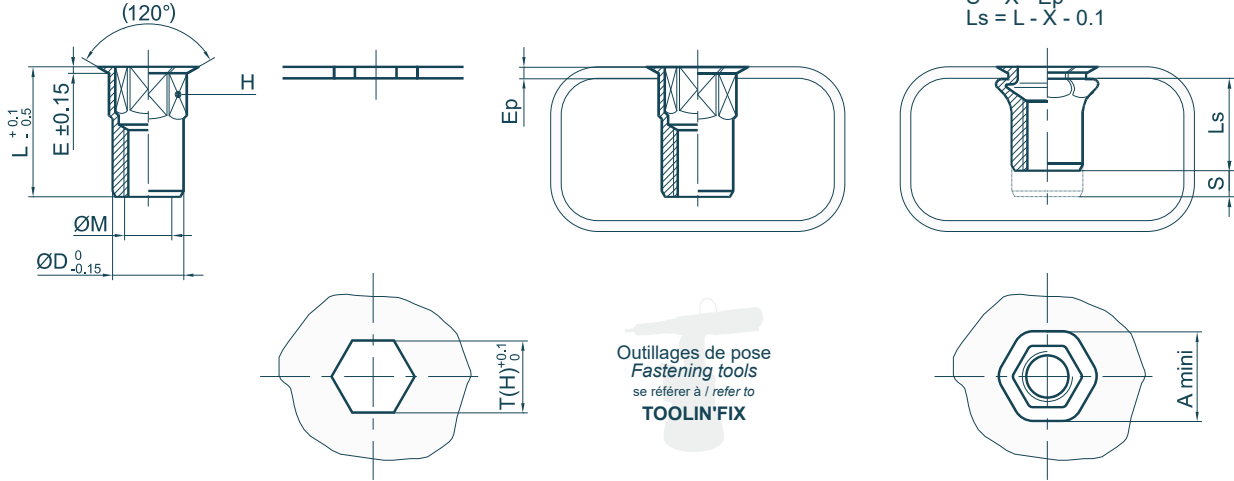

Outillages de pose
Fastening tools
se référer à / refer to
TOOLIN'FIX

Ø M	Ep min - max	Code	H	mm T(H)	A	L	E	Ø D	X indicative data				
M2.5 x 0.45	0.0 - 1.1	01A025AHO011Z	4.0	4.0	4.5	6.4	0.3	4.0	2.4	300	1.0	1.0	0.3
	1.1 - 1.7	01A025AHO017Z	4.0	4.0	4.5	7.0	0.3	4.0	3.0	300	1.0	1.0	0.3
M3 x 0.50	0.0 - 1.1	01A030AHO011Z	5.0	5.0	5.7	7.2	0.3	5.0	2.4	450	1.4	1.3	0.6
	1.0 - 2.3	01A030AHO023Z	5.0	5.0	5.7	8.6	0.3	5.0	3.6	450	1.4	1.3	0.6
	2.1 - 3.2	01A030AHO032Z	5.0	5.0	5.7	9.7	0.3	5.0	4.7	450	1.4	1.3	0.7
M4 x 0.70	3.0 - 4.1	01A030AHO041Z	5.0	5.0	5.7	10.6	0.3	5.0	5.6	450	1.4	1.3	0.7
	0.0 - 1.3	01A040AHO013Z	6.0	6.0	6.7	9.4	0.3	6.0	2.6	750	3.2	3.1	1.0
	1.0 - 3.0	01A040AHO030Z	6.0	6.0	6.7	11.1	0.3	6.0	4.3	750	3.2	3.1	1.1
	2.2 - 4.2	01A040AHO042Z	6.0	6.0	6.7	12.3	0.3	6.0	5.5	750	3.2	3.1	1.2
	4.0 - 5.5	01A040AHO055Z	6.0	6.0	6.7	13.5	0.3	6.0	6.8	750	3.2	3.1	1.2
M5 x 0.80	0.0 - 1.5	01A050AHO015Z	7.0	7.0	7.9	10.8	0.4	7.0	3.0	1050	6.4	6.1	1.5
	0.5 - 2.5	01A050AHO025Z	7.0	7.0	7.9	11.8	0.4	7.0	4.0	1050	6.4	6.1	1.5
	1.5 - 3.5	01A050AHO035Z*	7.0	7.0	7.7	12.8	0.35	7.0	5.0	1050	6.4	6.1	1.6
	1.5 - 3.5	01A050AHO035ZD	7.0	7.0	7.9	12.8	0.4	7.0	5.0	1050	6.4	6.1	1.6
	2.5 - 4.5	01A050AHO045Z	7.0	7.0	7.9	13.8	0.4	7.0	6.0	1050	6.4	6.1	1.7
	3.5 - 5.5	01A050AHO055Z	7.0	7.0	7.9	15.0	0.4	7.0	6.8	1050	6.4	6.1	1.7
	5.5 - 7.5	01A050AHO075Z	7.0	7.0	7.9	17.2	0.4	7.0	8.9	1050	6.4	6.1	1.8
	0.0 - 1.5	01A060AHO015Z	9.0	9.0	9.9	13.3	0.4	9.0	3.4	1800	11.1	10.6	3.3
M6 x 1.00	1.5 - 3.5	01A060AHO035Z*	9.0	9.0	9.7	15.3	0.35	9.0	5.4	1800	11.1	10.6	3.6
	1.5 - 3.5	01A060AHO035ZD	9.0	9.0	9.9	15.3	0.4	9.0	5.4	1800	11.1	10.6	3.6
	2.5 - 4.5	01A060AHO045Z	9.0	9.0	9.9	16.3	0.4	9.0	6.4	1800	11.1	10.6	3.8
	3.5 - 5.5	01A060AHO055Z	9.0	9.0	9.9	17.3	0.4	9.0	7.4	1800	11.1	10.6	3.9
	4.5 - 6.5	01A060AHO065Z	9.0	9.0	9.9	18.3	0.4	9.0	8.4	1800	11.1	10.6	4.2
	8 - 10.5	01A060AHO105Z	9.0	9.0	9.9	22.6	0.4	9.0	12.1	1800	11.1	10.6	4.2
	0.0 - 1.8	01A080AHO018Z	11.0	11.0	11.9	14.7	0.4	11.0	3.7	2950	27	25.8	4.9
M8 x 1.25	1.0 - 3.0	01A080AHO030Z	11.0	11.0	11.9	15.9	0.4	11.0	4.9	2950	27	25.8	5.1
	2.3 - 4.2	01A080AHO042Z	11.0	11.0	11.9	17.2	0.4	11.0	6.2	2950	27	25.8	5.4
	3.0 - 5.0	01A080AHO050Z*	11.0	11.0	11.7	17.8	0.35	11.0	6.9	2950	27	25.8	5.6
	3.0 - 5.0	01A080AHO050ZD	11.0	11.0	11.9	17.8	0.4	11.0	6.9	2950	27	25.8	5.6
	4.5 - 6.5	01A080AHO065Z	11.0	11.0	11.9	19.3	0.4	11.0	8.4	2950	27	25.8	5.9
	7 - 10	01A080AHO100Z	11.0	11.0	11.9	22.8	0.4	11.0	11.7	2950	27	25.8	6.5
	0.0 - 3.2	01A100AHO032Z	13.0	13.0	14.4	20.6	0.6	13.0	6.0	4000	53	51	8.8
M10 x 1.50	2.0 - 5.5	01A100AHO055Z	13.0	13.0	14.4	22.9	0.6	13.0	8.3	4000	53	51	9.4
	3.0 - 6.5	01A100AHO065Z	13.0	13.0	14.4	23.9	0.6	13.0	9.3	4000	53	51	9.7
	4.0 - 7.0	01A100AHO070Z	13.0	13.0	14.4	24.4	0.6	13.0	8.9	4000	53	51	10.0
	4.5 - 7.5	01A100AHO075Z	13.0	13.0	14.4	24.9	0.6	13.0	10.3	4000	53	51	10.0
	7.5 - 10.5	01A100AHO105Z	13.0	13.0	14.4	28.5	0.6	13.0	13	4000	53	51	10.0
M12 x 1.75	0.0 - 4.2	01A120AHO042Z	16.0	16.0	17.4	24.3	0.6	16.0	7.3	6100	92	88	15.8
	2.0 - 6.0	01A120AHO060Z	16.0	16.0	17.4	26.1	0.6	16.0	9.1	6100	92	88	16.6
	3.5 - 7.6	01A120AHO076Z	16.0	16.0	17.4	27.7	0.6	16.0	10.7	6100	92	88	17.3
	6.0 - 9.2	01A120AHO092Z	16.0	16.0	17.4	29.2	0.6	16.0	12.3	6100	92	88	17.9
	9.0 - 10	01A120AHO100Z	16.0	16.0	17.4	30.5	0.6	16.0	13.1	6100	92	88	17.9
M14 x 2.00	0.0 - 3.0	01A140AHO030Z	18.0	18.0	19.35	26.6	0.6	18.0	7.0	7200	148	142	21.9
	1.0 - 5.0	01A140AHO050Z	18.0	18.0	19.35	28.6	0.6	18.0	9.0	7200	148	142	23.1
	3.0 - 7.0	01A140AHO070Z	18.0	18.0	19.35	30.6	0.6	18.0	11.0	7200	148	142	24.4
	6.0 - 9.0	01A140AHO090Z	18.0	18.0	19.35	32.6	0.6	18.0	13.0	7200	148	142	25.7
M16 x 2.00	0.0 - 3.2	01A160AHO032Z	21.0	21.0	22.35	28.0	0.6	21.0	8.2	10000	232	222	30.7
	0.0 - 5.7	01A160AHO057Z	21.0	21.0	22.35	30.5	0.6	21.0	10.7	10000	232	222	32.6
	2.0 - 8.2	01A160AHO082Z	21.0	21.0	22.35	32.9	0.6	21.0	13.2	10000	232	222	34.5
	6.0 - 11	01A160AHO110Z	21.0	21.0	22.35	35.7	0.6	21.0	16.0	10000	232	222	36.6

* = Cold headed product Écrou à sertir en aveugle correspondant à l'ancienne désignation H ... FO ... ACIER
Blind Rivet Nuts corresponding to old designation H ... FO ... STEEL

Catalog found by Google search and provided by: **RIVET NUT USA™** RivetNutUSA.com | Sales@RivetNutUSA.com | 800.236.3200



Écrous à sertir en aveugle Blind Rivet Nuts



Matière : Acier

Material : Steel

Tête : Affleurante

Head : Flush

Fût : Cannelé

Body : Knurled



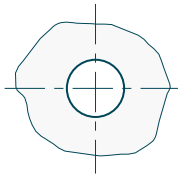
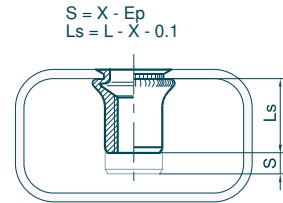
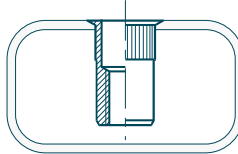
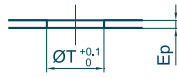
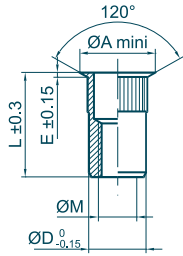

Extrémité du fût : Ouvert

Body end : Open Shape

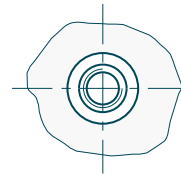

Outillages de pose
Fastening tools
se référer à / refer to
TOOLINFIX



Ø M	Ep		Code	mm ØT	Ø A	L	E	Ø D	X indicative data	 daN	 N.m	 N.m	 kg x1000
	min	max											
M2.5 x 0.45	0.0 - 1.1	1.1 - 1.7	01A025ACO011Z	4.0	4.6	6.4	0.3	4.0	2.4	300	1.0	0.8	0.3
	1.1 - 1.7		01A025ACO017Z	4.0	4.6	7.0	0.3	4.0	3.0	300	1.0	0.8	0.3
M3 x 0.50	0.0 - 1.1		01A030ACO011Z	5.0	5.8	7.2	0.3	5.0	2.4	450	1.4	1.0	0.6
	1.0 - 2.3		01A030ACO023Z	5.0	5.8	8.6	0.3	5.0	3.6	450	1.4	1.0	0.6
	2.1 - 3.2		01A030ACO032Z	5.0	5.8	9.7	0.3	5.0	4.7	450	1.4	1.0	0.7
	3.0 - 4.1		01A030ACO041Z	5.0	5.8	10.6	0.3	5.0	5.6	450	1.4	1.0	0.7
M4 x 0.70	0.0 - 1.3		01A040ACO013Z	6.0	6.8	9.4	0.3	6.0	2.6	750	3.2	2.1	1.0
	1.0 - 3.0		01A040ACO030Z	6.0	6.8	11.1	0.3	6.0	4.3	750	3.2	2.1	1.1
	2.2 - 4.2		01A040ACO042Z	6.0	6.8	12.3	0.3	6.0	5.5	750	3.2	2.1	1.2
	3.0 - 5.5		01A040ACO055Z	6.0	6.8	13.5	0.3	6.0	6.8	750	3.2	2.1	1.2
M5 x 0.80	0.0 - 1.5		01A050ACO015Z	7.0	8.0	10.8	0.4	7.0	3.0	1050	6.4	3.2	1.5
	0.5 - 2.5		01A050ACO025Z	7.0	8.0	11.8	0.4	7.0	4.0	1050	6.4	3.2	1.5
	1.5 - 3.5		01A050ACO035Z	7.0	8.0	12.8	0.4	7.0	5.0	1050	6.4	3.2	1.6
	2.5 - 4.5		01A050ACO045Z	7.0	8.0	13.8	0.4	7.0	6.0	1050	6.4	3.2	1.7
M6 x 1.00	0.0 - 1.5		01A060ACO015Z	9.0	10.0	13.3	0.4	9.0	3.4	1800	11.1	6.0	3.3
	1.5 - 3.5		01A060ACO035Z	9.0	10.0	15.3	0.4	9.0	5.4	1800	11.1	6.0	3.6
	2.5 - 4.5		01A060ACO045Z	9.0	10.0	16.3	0.4	9.0	6.4	1800	11.1	6.0	3.8
	3.5 - 5.5		01A060ACO055Z	9.0	10.0	17.3	0.4	9.0	7.4	1800	11.1	6.0	3.9
M8 x 1.25	4.5 - 6.5		01A060ACO065Z	9.0	10.0	18.3	0.4	9.0	8.4	1800	11.1	6.0	4.2
	0.0 - 1.8		01A080ACO018Z	11.0	12.0	14.7	0.4	11.0	3.7	2950	27	10.5	4.9
	1.0 - 3.0		01A080ACO030Z	11.0	12.0	15.9	0.4	11.0	4.9	2950	27	10.5	5.1
	2.3 - 4.2		01A080ACO042Z	11.0	12.0	17.2	0.4	11.0	6.2	2950	27	10.5	5.4
M10 x 1.50	3.0 - 5.0		01A080ACO050Z	11.0	12.0	17.8	0.4	11.0	6.9	2950	27	10.5	5.6
	4.5 - 6.5		01A080ACO065Z	11.0	12.0	19.3	0.4	11.0	8.4	2950	27	10.5	5.9
	0.0 - 3.2		01A100ACO032Z	13.0	14.5	20.6	0.6	13.0	6.0	4000	53	16.4	8.8
	2.0 - 5.5		01A100ACO055Z	13.0	14.5	22.9	0.6	13.0	8.3	4000	53	16.4	9.4
M12 x 1.75	3.0 - 6.5		01A100ACO065Z	13.0	14.5	23.9	0.6	13.0	9.3	4000	53	16.4	9.7
	4.5 - 7.5		01A100ACO075Z	13.0	14.5	24.9	0.6	13.0	10.3	4000	53	16.4	10.0
	0.0 - 4.2		01A120ACO042Z	16.0	17.5	24.3	0.6	16.0	7.3	6100	92	23.5	15.8
	2.0 - 6.0		01A120ACO060Z	16.0	17.5	26.1	0.6	16.0	9.1	6100	92	23.5	16.6
M14 x 2.00	3.5 - 7.6		01A120ACO076Z	16.0	17.5	27.7	0.6	16.0	10.7	6100	92	23.5	17.3
	6.0 - 9.2		01A120ACO092Z	16.0	17.5	29.2	0.6	16.0	12.3	6100	92	23.5	17.9
	0.0 - 3.0		01A140ACO030Z	18.0	19.5	26.6	0.6	18.0	7.0	7200	148	31.5	21.9
	1.0 - 5.0		01A140ACO050Z	18.0	19.5	28.6	0.6	18.0	9.0	7200	148	31.5	23.1
M16 x 2.00	3.0 - 7.0		01A140ACO070Z	18.0	19.5	30.6	0.6	18.0	11.0	7200	148	31.5	24.4
	6.0 - 9.0		01A140ACO090Z	18.0	19.5	32.6	0.6	18.0	13.0	7200	148	31.5	25.7
	0.0 - 3.2		01A160ACO032Z	21.0	22.5	28.0	0.6	21.0	8.2	10000	232	41	30.7
	0.0 - 5.7		01A160ACO057Z	21.0	22.5	30.5	0.6	21.0	10.7	10000	232	41	32.6
M16 x 2.00	2.0 - 8.2		01A160ACO082Z	21.0	22.5	32.9	0.6	21.0	13.2	10000	232	41	34.5
	6.0 - 11.0		01A160ACO110Z	21.0	22.5	35.7	0.6	21.0	16.0	10000	232	41	36.6

Écrou à sertir en aveugle correspondant à l'ancienne désignation C ... IO ... ACIER
Blind Rivet Nuts corresponding to old designation C ... IO ... STEEL

Écrous à sertir en aveugle Blind Rivet Nuts



Matière : Acier

Material : Steel

Tête : Cylindrique

Head : Flange

Fût : Cylindrique

Body : Round

Extrémité du fût : Ouvert

Body end : Open Shape

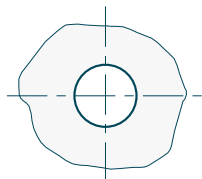
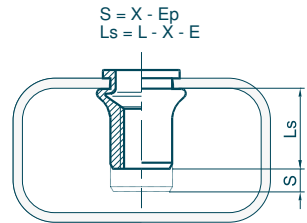
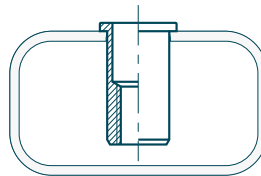
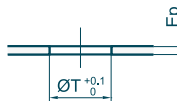
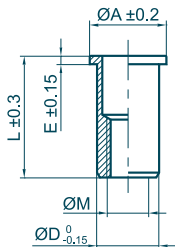

Outillages de pose
Fastening tools
se référer à / refer to
TOOLINFIX

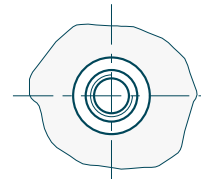

Ø M	Ep min - max	Code	mm ØT	Ø A	L	E	Ø D	X indicative data				kg x1000
M2.5 x 0.45	0.0 - 1.1	01A025CRO011Z	4.0	6.0	6.9	0.6	4.0	2.4	300	1.0	0.8	0.4
	0.8 - 1.7	01A025CRO017Z	4.0	6.0	7.5	0.6	4.0	3.0	300	1.0	0.8	0.4
M3 x 0.50	0.0 - 1.1	01A030CRO011Z	5.0	7.0	7.9	0.8	5.0	2.2	450	1.4	1.0	0.7
	0.0 - 1.7	01A030CRO017Z	5.0	7.0	8.5	0.8	5.0	2.8	450	1.4	1.0	0.7
	1.0 - 2.3	01A030CRO023Z	5.0	7.0	9.1	0.8	5.0	3.4	450	1.4	1.0	0.7
M4 x 0.70	1.8 - 3.0	01A030CRO030Z	5.0	7.0	9.7	0.8	5.0	4.0	450	1.4	1.0	0.8
	0.0 - 1.3	01A040CRO013Z	6.0	8.0	10.1	0.8	6.0	2.6	750	3.2	2.1	1.2
	0.0 - 2.1	01A040CRO021Z	6.0	8.0	10.9	0.8	6.0	3.4	750	3.2	2.1	1.2
M5 x 0.80	0.5 - 3.0	01A040CRO030Z	6.0	8.0	11.9	0.8	6.0	4.3	750	3.2	2.1	1.3
	1.3 - 3.7	01A040CRO037Z	6.0	8.0	12.5	0.8	6.0	5.0	750	3.2	2.1	1.3
	0.0 - 1.5	01A050CRO015Z	7.0	9.0	11.7	1.0	7.0	3.0	1050	6.4	3.2	1.7
M6 x 1.00	0.0 - 2.5	01A050CRO025Z	7.0	9.0	12.7	1.0	7.0	4.0	1050	6.4	3.2	1.8
	0.5 - 3.5	01A050CRO035Z	7.0	9.0	13.7	1.0	7.0	5.0	1050	6.4	3.2	1.9
	1.5 - 4.5	01A050CRO045Z	7.0	9.0	14.7	1.0	7.0	6.0	1050	6.4	3.2	2.0
M8 x 1.25	0.0 - 1.5	01A060CRO015Z	9.0	11.0	14.4	1.2	9.0	3.4	1800	11.1	6.0	3.8
	0.0 - 2.5	01A060CRO025Z	9.0	11.0	15.4	1.2	9.0	4.4	1800	11.1	6.0	3.9
	1.0 - 3.5	01A060CRO035Z	9.0	11.0	16.4	1.2	9.0	5.4	1800	11.1	6.0	4.1
M10 x 1.50	2.0 - 4.5	01A060CRO045Z	9.0	11.0	17.4	1.2	9.0	6.4	1800	11.1	6.0	4.2
	3.0 - 5.5	01A060CRO055Z	9.0	11.0	18.4	1.2	9.0	7.4	1800	11.1	6.0	4.4
	0.0 - 1.8	01A080CRO018Z	11.0	14.0	16.0	1.5	11.0	3.7	2950	27	10.5	5.9
M12 x 1.75	0.0 - 3.0	01A080CRO030Z	11.0	14.0	17.3	1.5	11.0	4.9	2950	27	10.5	6.2
	1.2 - 4.2	01A080CRO042Z	11.0	14.0	18.4	1.5	11.0	6.1	2950	27	10.5	6.4
	2.0 - 5.0	01A080CRO050Z	11.0	14.0	19.5	1.5	11.0	6.9	2950	27	10.5	6.7
M14 x 2.00	3.5 - 6.5	01A080CRO065Z	11.0	14.0	20.7	1.5	11.0	8.4	2950	27	10.5	6.9
	0.0 - 2.5	01A100CRO025Z	13.0	16.0	21.3	1.5	13.0	5.3	4000	53	16.4	9.7
	0.5 - 4.0	01A100CRO040Z	13.0	16.0	22.8	1.5	13.0	6.8	4000	53	16.4	10.1
M16 x 2.00	2.0 - 5.5	01A100CRO055Z	13.0	16.0	24.5	1.5	13.0	8.3	4000	53	16.4	10.6
	4.0 - 7.0	01A100CRO070Z	13.0	16.0	25.8	1.5	13.0	9.8	4000	53	16.4	11.0
	0.0 - 4.2	01A120CRO042Z	16.0	20.0	25.9	1.7	16.0	7.3	6100	92	23.5	17.9
M18 x 2.00	2.0 - 6.0	01A120CRO060Z	16.0	20.0	27.7	1.7	16.0	9.1	6100	92	23.5	18.7
	3.5 - 7.6	01A120CRO076Z	16.0	20.0	29.3	1.7	16.0	10.7	6100	92	23.5	19.4
	6.0 - 9.2	01A120CRO092Z	16.0	20.0	30.9	1.7	16.0	12.3	6100	92	23.5	20.0
M20 x 2.00	0.0 - 3.0	01A140CRO030Z	18.0	23.0	28.6	2.0	18.0	7.0	7200	148	31.5	25.6
	1.0 - 5.0	01A140CRO050Z	18.0	23.0	30.5	2.0	18.0	9.0	7200	148	31.5	26.7
	3.0 - 7.0	01A140CRO070Z	18.0	23.0	32.5	2.0	18.0	11.0	7200	148	31.5	28.1
M22 x 2.00	6.0 - 9.0	01A140CRO090Z	18.0	23.0	34.5	2.0	18.0	13.0	7200	148	31.5	29.3
	0.0 - 3.2	01A160CRO032Z	21.0	26.0	30.3	2.5	21.0	8.2	10000	232	41	36.1
	0.0 - 5.7	01A160CRO057Z	21.0	26.0	32.8	2.5	21.0	10.7	10000	232	41	38.0
M24 x 2.00	2.0 - 8.2	01A160CRO082Z	21.0	26.0	35.3	2.5	21.0	13.2	10000	232	41	39.9
	6.0 - 11.0	01A160CRO110Z	21.0	26.0	38.1	2.5	21.0	16.0	10000	232	41	42.0

Écrou à sertir en aveugle correspondant à l'ancienne désignation M ... CO ... ACIER
Blind Rivet Nuts corresponding to old designation M ... CO ... STEEL



Écrous à sertir en aveugle Blind Rivet Nuts



Matière : Acier Material : Steel
 Tête : Fraisée Head : Countersunk
 Fût : Cylindrique Body : Round
 Extrémité du fût : Ouvert Body end : Open Shape

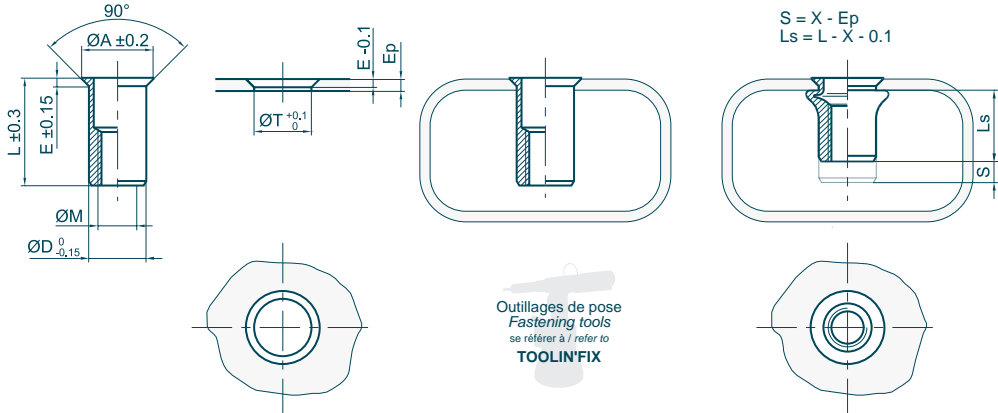

Outillages de pose
Fastening tools
se référer à / refer to
TOULIN'FIX

Ø M	Ep		Code	mm ØT	Ø A	L	E	Ø D	X indicative data				kg x1000
	min	max											
M2.5 x 0.45	0.8 - 1.7		01A025FRO017Z	4.0	5.0	7.0	0.4	4.0	3.0	300	1.0	0.8	0.3
M3 x 0.50	1.1 - 1.7		01A030FRO017Z	5.0	6.8	7.8	1.0	5.0	2.8	450	1.4	1.0	0.6
	1.1 - 2.3		01A030FRO023Z	5.0	6.8	8.4	1.0	5.0	3.4	450	1.4	1.0	0.7
	1.8 - 3.0		01A030FRO030Z	5.0	6.8	9.0	1.0	5.0	4.0	450	1.4	1.0	0.7
	1.1 - 2.1		01A040FRO021Z	6.0	7.8	10.2	1.0	6.0	3.4	750	3.2	2.1	1.1
M4 x 0.70	1.1 - 3.0		01A040FRO030Z	6.0	7.8	11.1	1.0	6.0	4.3	750	3.2	2.1	1.1
	1.3 - 3.7		01A040FRO037Z	6.0	7.8	11.8	1.0	6.0	5.0	750	3.2	2.1	1.2
	1.1 - 2.5		01A050FRO025Z	7.0	8.8	11.8	1.0	7.0	4.0	1080	6.4	3.2	1.6
	1.1 - 3.5		01A050FRO035Z	7.0	8.8	12.8	1.0	7.0	5.0	1080	6.4	3.2	1.7
M5 x 0.80	1.5 - 4.5		01A050FRO045Z	7.0	8.8	13.8	1.0	7.0	6.0	1080	6.4	3.2	1.8
	1.1 - 2.5		01A060FRO025Z	9.0	10.8	14.3	1.0	9.0	4.4	1800	11.1	6.0	3.6
	1.1 - 3.5		01A060FRO035Z	9.0	10.8	15.3	1.0	9.0	5.4	1800	11.1	6.0	3.7
	2.0 - 4.5		01A060FRO045Z	9.0	10.8	16.3	1.0	9.0	6.4	1800	11.1	6.0	3.9
M6 x 1.00	3.0 - 5.5		01A060FRO055Z	9.0	10.8	17.3	1.0	9.0	7.4	1800	11.1	6.0	4.0
	1.8 - 3.0		01A080FRO030Z	11.0	13.8	15.8	1.5	11.0	4.9	2950	27	10.5	5.4
	1.8 - 4.2		01A080FRO042Z	11.0	13.8	17.0	1.5	11.0	6.1	2950	27	10.5	5.7
	2.0 - 5.0		01A080FRO050Z	11.0	13.8	17.8	1.5	11.0	6.9	2950	27	10.5	5.9
M8 x 1.25	3.5 - 6.5		01A080FRO065Z	11.0	13.8	19.3	1.5	11.0	8.4	2950	27	10.5	6.2
	1.8 - 4.0		01A100FRO040Z	13.0	15.8	21.4	1.5	13.0	6.8	4000	53	16.4	9.3
	2.0 - 5.5		01A100FRO055Z	13.0	15.8	22.9	1.5	13.0	8.3	4000	53	16.4	9.7
	4.0 - 7.0		01A100FRO070Z	13.0	15.8	24.4	1.5	13.0	9.8	4000	53	16.4	10.1
M10 x 1.50	2.5 - 4.2		01A120FRO042Z	16.0	19.8	24.3	2.0	16.0	7.3	6100	92	23.5	16.6
	2.0 - 6.0		01A120FRO060Z	16.0	19.8	26.1	2.0	16.0	9.1	6100	92	23.5	17.3
	3.5 - 7.6		01A120FRO076Z	16.0	19.8	27.7	2.0	16.0	10.7	6100	92	23.5	18.0
	6.0 - 9.2		01A120FRO092Z	16.0	19.8	29.3	2.0	16.0	12.3	6100	92	23.5	18.6
M12 x 1.75	1.0 - 5.0		01A140FRO050Z	18.0	22.8	28.7	2.5	18.0	9.0	7200	148	31.5	24.5
	3.0 - 7.0		01A140FRO070Z	18.0	22.8	30.6	2.5	18.0	11.0	7200	148	31.5	25.8
	6.0 - 9.0		01A140FRO090Z	18.0	22.8	32.6	2.5	18.0	13.0	7200	148	31.5	27.1
M14 x 2.00	3.0 - 5.7		01A160FRO057Z	21.0	25.8	30.4	2.5	21.0	10.7	10000	232	41	34.2
	2.0 - 8.2		01A160FRO082Z	21.0	25.8	32.9	2.5	21.0	13.2	10000	232	41	36.1
	6.0 - 11.0		01A160FRO110Z	21.0	25.8	35.7	2.5	21.0	16.0	10000	232	41	38.2

Écrou à sertir en aveugle correspondant à l'ancienne désignation M ... FO ... ACIER
 Blind Rivet Nuts corresponding to old designation M ... FO ... STEEL



Écrous à sertir en aveugle Blind Rivet Nuts



Matière : Acier

Material : Steel

Tête : Cylindrique

Head : Flange

Fût : Cannelé

Body : Knurled

Extrémité du fût : Ouvert

Body end : Open Shape

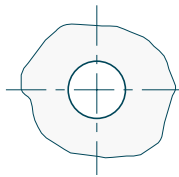
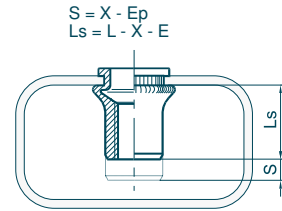
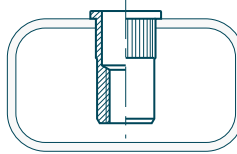
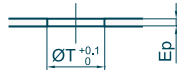
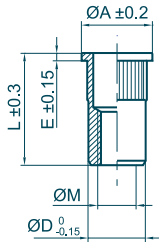

Outillages de pose
Fastening tools
se référer à / refer to
TOOLINFIX

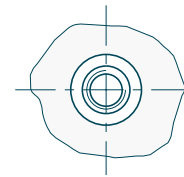

Ø M	Ep		Code	mm ØT	Ø A	L	E	Ø D	X indicative data				kg x1000
	min	max											
M2.5 x 0.45	0.0 - 1.1	1.1 - 1.7	01A025CCO011Z	4.0	6.0	6.9	0.6	4.0	2.4	300	1.0	0.8	0.4
	1.1 - 1.7	1.7 - 2.3	01A025CCO017Z	4.0	6.0	7.5	0.6	4.0	3.0	300	1.0	0.8	0.4
M3 x 0.50	0.0 - 1.1	1.1 - 1.7	01A030CCO011Z	5.0	7.0	7.9	0.8	5.0	2.2	450	1.4	1.0	0.7
	0.0 - 1.7	1.7 - 2.3	01A030CCO017Z	5.0	7.0	8.5	0.8	5.0	2.8	450	1.4	1.0	0.7
	1.0 - 2.3	2.3 - 3.0	01A030CCO023Z	5.0	7.0	9.1	0.8	5.0	3.4	450	1.4	1.0	0.7
	1.8 - 3.0	3.0 - 3.7	01A030CCO030Z	5.0	7.0	9.7	0.8	5.0	4.0	450	1.4	1.0	0.8
M4 x 0.70	0.0 - 1.3	1.3 - 2.0	01A040CCO013Z	6.0	8.0	10.1	0.8	6.0	2.6	750	3.2	2.1	1.2
	0.0 - 2.1	2.1 - 2.8	01A040CCO021Z	6.0	8.0	10.9	0.8	6.0	3.4	750	3.2	2.1	1.2
	1.0 - 3.0	3.0 - 3.7	01A040CCO030Z	6.0	8.0	11.9	0.8	6.0	4.3	750	3.2	2.1	1.3
	1.7 - 3.7	3.7 - 4.4	01A040CCO037Z	6.0	8.0	12.5	0.8	6.0	5.0	750	3.2	2.1	1.3
M5 x 0.80	0.0 - 1.5	1.5 - 2.2	01A050CCO015Z	7.0	9.0	11.7	1.0	7.0	3.0	1050	6.4	3.2	1.7
	0.0 - 2.5	2.5 - 3.2	01A050CCO025Z	7.0	9.0	12.7	1.0	7.0	4.0	1050	6.4	3.2	1.8
	1.5 - 3.5	3.5 - 4.2	01A050CCO035Z	7.0	9.0	13.7	1.0	7.0	5.0	1050	6.4	3.2	1.9
	2.5 - 4.5	4.5 - 5.2	01A050CCO045Z	7.0	9.0	14.7	1.0	7.0	6.0	1050	6.4	3.2	2.0
M6 x 1.00	0.0 - 1.5	1.5 - 2.2	01A060CCO015Z	9.0	11.0	14.4	1.2	9.0	3.4	1800	11.1	6.0	3.8
	0.5 - 2.5	2.5 - 3.2	01A060CCO025Z	9.0	11.0	15.4	1.2	9.0	4.4	1800	11.1	6.0	3.9
	1.5 - 3.5	3.5 - 4.2	01A060CCO035Z	9.0	11.0	16.4	1.2	9.0	5.4	1800	11.1	6.0	4.1
	2.5 - 4.5	4.5 - 5.2	01A060CCO045Z	9.0	11.0	17.4	1.2	9.0	6.4	1800	11.1	6.0	4.2
M8 x 1.25	0.0 - 1.8	1.8 - 2.5	01A080CCO018Z	11.0	14.0	16.0	1.5	11.0	3.7	2950	27	10.5	5.9
	1.0 - 3.0	3.0 - 3.7	01A080CCO030Z	11.0	14.0	17.3	1.5	11.0	4.9	2950	27	10.5	6.1
	2.2 - 4.2	4.2 - 4.9	01A080CCO042Z	11.0	14.0	18.4	1.5	11.0	6.1	2950	27	10.5	6.4
	3.0 - 5.0	5.0 - 5.7	01A080CCO050Z	11.0	14.0	19.5	1.5	11.0	6.9	2950	27	10.5	6.7
M10 x 1.50	0.0 - 2.5	2.5 - 3.2	01A100CCO025Z	13.0	16.0	21.3	1.5	13.0	5.3	4000	53	16.4	9.7
	0.5 - 4.0	4.0 - 4.7	01A100CCO040Z	13.0	16.0	22.8	1.5	13.0	6.8	4000	53	16.4	10.1
	2.0 - 5.5	5.5 - 6.2	01A100CCO055Z	13.0	16.0	24.5	1.5	13.0	8.3	4000	53	16.4	10.6
	4.0 - 7.0	7.0 - 7.7	01A100CCO070Z	13.0	16.0	25.8	1.5	13.0	9.8	4000	53	16.4	11.0
M12 x 1.75	0.0 - 4.2	4.2 - 4.9	01A120CCO042Z	16.0	20.0	25.9	1.7	16.0	7.3	6100	92	23.5	17.9
	2.0 - 6.0	6.0 - 6.7	01A120CCO060Z	16.0	20.0	27.7	1.7	16.0	9.1	6100	92	23.5	18.7
	3.5 - 7.6	7.6 - 8.3	01A120CCO076Z	16.0	20.0	29.3	1.7	16.0	10.7	6100	92	23.5	19.4
	6.0 - 9.2	9.2 - 9.9	01A120CCO092Z	16.0	20.0	30.9	1.7	16.0	12.3	6100	92	23.5	20.0
M14 x 2.00	0.0 - 3.0	3.0 - 3.7	01A140CCO030Z	18.0	23.0	28.6	2.0	18.0	7.0	7200	148	31.5	25.6
	1.0 - 5.0	5.0 - 5.7	01A140CCO050Z	18.0	23.0	30.5	2.0	18.0	9.0	7200	148	31.5	26.7
	3.0 - 7.0	7.0 - 7.7	01A140CCO070Z	18.0	23.0	32.5	2.0	18.0	11.0	7200	148	31.5	28.1
	6.0 - 9.0	9.0 - 9.7	01A140CCO090Z	18.0	23.0	34.5	2.0	18.0	13.0	7200	148	31.5	29.3
M16 x 2.00	0.0 - 3.2	3.2 - 3.9	01A160CCO032Z	21.0	26.0	30.3	2.5	21.0	8.2	10000	232	41	36.1
	0.0 - 5.7	5.7 - 6.4	01A160CCO057Z	21.0	26.0	32.8	2.5	21.0	10.7	10000	232	41	38.0
	2.0 - 8.2	8.2 - 8.9	01A160CCO082Z	21.0	26.0	35.3	2.5	21.0	13.2	10000	232	41	39.9
	6.0 - 11.0	11.0 - 11.7	01A160CCO110Z	21.0	26.0	38.1	2.5	21.0	16.0	10000	232	41	42.0

Écrou à sertir en aveugle correspondant à l'ancienne désignation C ... CO ... ACIER
Blind Rivet Nuts corresponding to old designation C ... CO ... STEEL

Écrous à sertir en aveugle
Blind Rivet Nuts



Material : Steel

Matière : Acier

Head : Flange

Tête : Cylindrique

Body : Knurled



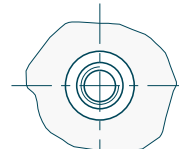
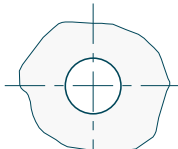
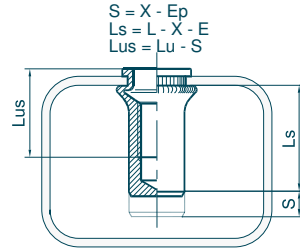
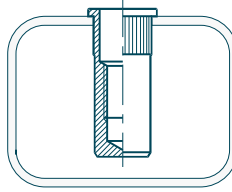
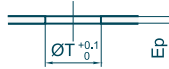
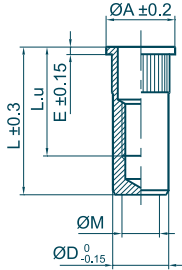

Fût : Cannelé

Body end : Closed End

Extrémité du fût : Borgne



Outillages de pose
Fastening tools
se référer à / refer to
TOOLIN'FIX

Ø M	Ep		Code	mm ØT	Ø A	L	L.u	E	Ø D	X indicative data				
	min	max												
M2.5 x 0.45	0.0 - 1.1	1.1 - 1.7	01A025CCB011Z	4.0	6.0	10.2	6.1	0.6	4.0	2.4	300	1.0	0.8	0.6
	0.0 - 1.1	1.1 - 1.7	01A025CCB017Z	4.0	6.0	10.8	7.0	0.6	4.0	3.0	300	1.0	0.8	0.6
M3 x 0.50	0.0 - 1.1	1.1 - 1.7	01A030CCB011Z	5.0	7.0	12.4	7.0	0.8	5.0	2.2	450	1.4	1.0	1.2
	0.0 - 1.7	1.7 - 3.0	01A030CCB017Z	5.0	7.0	13.0	7.5	0.8	5.0	2.8	450	1.4	1.0	1.3
M4 x 0.70	0.0 - 1.3	1.3 - 3.0	01A030CCB023Z	5.0	7.0	13.6	8.5	0.8	5.0	3.4	450	1.4	1.0	1.3
	0.0 - 2.1	2.1 - 3.7	01A030CCB030Z	5.0	7.0	14.2	8.7	0.8	5.0	4.0	450	1.4	1.0	1.3
M5 x 0.80	0.0 - 1.3	1.3 - 3.0	01A040CCB013Z	6.0	8.0	15.8	9.5	0.8	6.0	2.6	750	3.2	2.1	2.1
	0.0 - 2.1	2.1 - 3.7	01A040CCB021Z	6.0	8.0	16.6	10.0	0.8	6.0	3.4	750	3.2	2.1	2.1
M6 x 1.00	0.0 - 1.5	1.5 - 3.5	01A040CCB030Z	6.0	8.0	17.5	11.1	0.8	6.0	4.3	750	3.2	2.1	2.2
	0.0 - 1.5	1.5 - 3.5	01A040CCB037Z	6.0	8.0	18.2	12.0	0.8	6.0	5.0	750	3.2	2.1	2.2
M8 x 1.25	0.0 - 1.5	1.5 - 3.5	01A050CCB015Z	7.0	9.0	18.2	11.0	1.0	7.0	3.0	1050	6.4	3.2	3.1
	0.0 - 2.5	2.5 - 4.5	01A050CCB025Z	7.0	9.0	19.2	12.0	1.0	7.0	4.0	1050	6.4	3.2	3.2
M10 x 1.50	0.0 - 2.5	2.5 - 4.5	01A050CCB035Z	7.0	9.0	20.2	13.0	1.0	7.0	5.0	1050	6.4	3.2	3.3
	0.0 - 1.5	1.5 - 3.5	01A050CCB045Z	7.0	9.0	21.2	14.0	1.0	7.0	6.0	1050	6.4	3.2	3.3
M12 x 1.75	0.0 - 1.5	1.5 - 3.5	01A060CCB015Z	9.0	11.0	22.4	14.0	1.2	9.0	3.4	1800	11.1	6.0	6.7
	0.0 - 2.5	2.5 - 4.5	01A060CCB025Z	9.0	11.0	23.4	15.0	1.2	9.0	4.4	1800	11.1	6.0	6.9
M14 x 2.00	0.0 - 2.5	2.5 - 4.5	01A060CCB035Z	9.0	11.0	24.4	16.5	1.2	9.0	5.4	1800	11.1	6.0	7.0
	0.0 - 1.5	1.5 - 3.5	01A060CCB045Z	9.0	11.0	25.4	17.5	1.2	9.0	6.4	1800	11.1	6.0	7.2
M16 x 2.00	0.0 - 1.5	1.5 - 3.5	01A060CCB055Z	9.0	11.0	26.4	18.5	1.2	9.0	7.4	1800	11.1	6.0	7.3
	0.0 - 1.8	1.8 - 3.0	01A080CCB018Z	11.0	14.0	25.5	17.1	1.5	11.0	3.7	2950	27	10.5	10.6
M18 x 2.25	0.0 - 3.0	3.0 - 4.2	01A080CCB030Z	11.0	14.0	26.7	18.1	1.5	11.0	4.9	2950	27	10.5	10.9
	0.0 - 4.2	4.2 - 6.0	01A080CCB042Z	11.0	14.0	27.9	19.1	1.5	11.0	6.1	2950	27	10.5	11.2
M20 x 2.50	0.0 - 3.0	3.0 - 4.2	01A080CCB050Z	11.0	14.0	28.7	19.7	1.5	11.0	6.9	2950	27	10.5	11.5
	0.0 - 4.2	4.2 - 6.0	01A080CCB065Z	11.0	14.0	30.2	21.0	1.5	11.0	8.4	2950	27	10.5	11.7
M22 x 2.75	0.0 - 2.5	2.5 - 4.5	01A100CCB025Z	13.0	16.0	32.8	21.0	1.5	13.0	5.3	4000	53	16.4	17.4
	0.0 - 4.2	4.2 - 6.0	01A100CCB040Z	13.0	16.0	34.3	22.5	1.5	13.0	6.8	4000	53	16.4	17.9
M24 x 3.00	0.0 - 2.5	2.5 - 4.5	01A100CCB055Z	13.0	16.0	35.8	24.0	1.5	13.0	8.3	4000	53	16.4	18.3
	0.0 - 4.2	4.2 - 6.0	01A100CCB070Z	13.0	16.0	37.3	27.0	1.5	13.0	9.8	4000	53	16.4	18.6
M26 x 3.25	0.0 - 4.2	4.2 - 6.0	01A120CCB042Z	16.0	20.0	37.9	25.4	1.7	16.0	7.3	6100	92	23.5	30.6
	0.0 - 6.0	6.0 - 9.2	01A120CCB060Z	16.0	20.0	39.7	27.2	1.7	16.0	9.1	6100	92	23.5	31.3
M28 x 3.50	0.0 - 6.0	6.0 - 9.2	01A120CCB076Z	16.0	20.0	41.3	28.5	1.7	16.0	10.7	6100	92	23.5	32.1
	0.0 - 9.2	9.2 - 12.0	01A120CCB092Z	16.0	20.0	42.9	30.1	1.7	16.0	12.3	6100	92	23.5	32.7
M30 x 3.75	0.0 - 3.0	3.0 - 4.2	01A140CCB030Z	18.0	23.0	43.6	29.6	2.0	18.0	7.0	7200	148	31.5	44.4
	0.0 - 5.0	5.0 - 7.0	01A140CCB050Z	18.0	23.0	45.5	31.5	2.0	18.0	9.0	7200	148	31.5	45.6
M32 x 4.00	0.0 - 7.0	7.0 - 10.0	01A140CCB070Z	18.0	23.0	47.5	33.5	2.0	18.0	11.0	7200	148	31.5	46.9
	0.0 - 9.0	9.0 - 12.0	01A140CCB090Z	18.0	23.0	49.5	35.5	2.0	18.0	13.0	7200	148	31.5	48.2
M36 x 4.50	0.0 - 3.2	3.2 - 4.2	01A160CCB032Z	21.0	26.0	46.3	30.5	2.5	21.0	8.2	10000	232	41	63.9
	0.0 - 5.7	5.7 - 7.0	01A160CCB057Z	21.0	26.0	48.8	33.0	2.5	21.0	10.7	10000	232	41	65.8
M40 x 5.00	2.0 - 8.2	8.2 - 11.0	01A160CCB082Z	21.0	26.0	51.3	35.5	2.5	21.0	13.2	10000	232	41	67.7
	2.0 - 11.0	11.0 - 14.0	01A160CCB110Z	21.0	26.0	54.1	38.0	2.5	21.0	16.0	10000	232	41	69.9

Écrou à sertir en aveugle correspondant à l'ancienne désignation C ... CB ... ACIER
Blind Rivet Nuts corresponding to old designation C ... CB ... STEEL

Écrous à sertir en aveugle Blind Rivet Nuts



Matière : Acier Material : Steel
 Tête : Fraisée Head : Countersunk
 Fût : Hexagonal Body : Hexagonal
 Extrémité du fût : Ouvert Body end : Open Shape

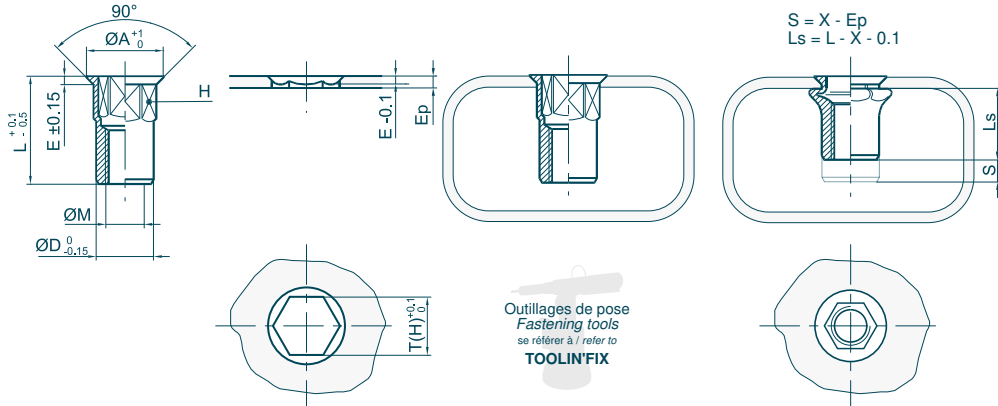

Ø M	Ep min - max	Code	H	mm T(H)	Ø A	L	E	Ø D	X indicative data	daN			kg x1000
										daN	N.m	N.m	
M2.5 x 0.45	1.1 - 1.7	01A025FHO017Z	4.0	4.0	5.0	7.0	0.6	4.0	3.0	300	1.0	1.0	0.3
M3 x 0.50	1.1 - 1.7	01A030FHO017Z	5.0	5.0	6.8	7.8	1.0	5.0	2.8	450	1.4	1.3	0.6
	1.1 - 2.3	01A030FHO023Z	5.0	5.0	6.8	8.4	1.0	5.0	3.4	450	1.4	1.3	0.7
	1.8 - 3.0	01A030FHO030Z	5.0	5.0	6.8	9.0	1.0	5.0	4.0	450	1.4	1.3	0.7
M4 x 0.70	1.1 - 2.1	01A040FHO021Z	6.0	6.0	7.8	10.2	1.0	6.0	3.4	750	3.2	3.1	1.1
	1.1 - 3.0	01A040FHO030Z	6.0	6.0	7.8	11.1	1.0	6.0	4.3	750	3.2	3.1	1.1
	1.7 - 3.7	01A040FHO037Z	6.0	6.0	7.8	11.8	1.0	6.0	5.0	750	3.2	3.1	1.2
M5 x 0.80	1.1 - 2.5	01A050FHO025Z	7.0	7.0	8.8	11.8	1.0	7.0	4.0	1080	6.4	6.1	1.6
	1.5 - 3.5	01A050FHO035Z	7.0	7.0	8.8	12.8	1.0	7.0	5.0	1080	6.4	6.1	1.7
	2.5 - 4.5	01A050FHO045Z	7.0	7.0	8.8	13.8	1.0	7.0	6.0	1080	6.4	6.1	1.8
M6 x 1.00	1.1 - 2.5	01A060FHO025Z	9.0	9.0	10.8	14.3	1.0	9.0	4.4	1800	11.1	10.6	3.6
	1.5 - 3.5	01A060FHO035Z	9.0	9.0	10.8	15.3	1.0	9.0	5.4	1800	11.1	10.6	3.7
	2.5 - 4.5	01A060FHO045Z	9.0	9.0	10.8	16.3	1.0	9.0	6.4	1800	11.1	10.6	3.9
	3.5 - 5.5	01A060FHO055Z	9.0	9.0	10.8	17.3	1.0	9.0	7.4	1800	11.1	10.6	4.0
	4.5 - 6.5	01A060FHO065Z	9.0	9.0	10.8	18.3	1.0	9.0	8.4	1800	11.1	10.6	4.2
M8 x 1.25	1.8 - 3.0	01A080FHO030Z	11.0	11.0	13.8	15.8	1.5	11.0	4.9	2950	27	25.8	5.4
	2.2 - 4.2	01A080FHO042Z	11.0	11.0	13.8	17.0	1.5	11.0	6.1	2950	27	25.8	5.7
	3.0 - 5.0	01A080FHO050Z	11.0	11.0	13.8	17.8	1.5	11.0	6.9	2950	27	25.8	5.9
	4.5 - 6.5	01A080FHO065Z	11.0	11.0	13.8	19.3	1.5	11.0	8.4	2950	27	25.8	6.2
M10 x 1.50	1.8 - 4.0	01A100FHO040Z	13.0	13.0	15.8	21.4	1.5	13.0	6.8	4000	53	51	9.3
	2.0 - 5.5	01A100FHO055Z	13.0	13.0	15.8	22.9	1.5	13.0	8.3	4000	53	51	9.7
	4.0 - 7.0	01A100FHO070Z	13.0	13.0	15.8	24.4	1.5	13.0	9.8	4000	53	51	10.1
M12 x 1.75	2.5 - 4.2	01A120FHO042Z	16.0	16.0	19.8	24.3	2.0	16.0	7.3	6100	92	88	16.6
	2.5 - 6.0	01A120FHO060Z	16.0	16.0	19.8	26.1	2.0	16.0	9.1	6100	92	88	17.3
	3.5 - 7.6	01A120FHO076Z	16.0	16.0	19.8	27.7	2.0	16.0	10.7	6100	92	88	18.0
	6.0 - 9.2	01A120FHO092Z	16.0	16.0	19.8	29.3	2.0	16.0	12.3	6100	92	88	18.6
M14 x 2.00	1.0 - 5.0	01A140FHO050Z	18.0	18.0	22.8	28.7	2.5	18.0	9.0	7200	148	142	24.5
	3.0 - 7.0	01A140FHO070Z	18.0	18.0	22.8	30.6	2.5	18.0	11.0	7200	148	142	25.8
	6.0 - 9.0	01A140FHO090Z	18.0	18.0	22.8	32.6	2.5	18.0	13.0	7200	148	142	27.1
M16 x 2.00	3.0 - 5.7	01A160FHO057Z	21.0	21.0	25.8	30.4	2.5	21.0	10.7	10000	232	222	34.2
	2.0 - 8.2	01A160FHO082Z	21.0	21.0	25.8	32.9	2.5	21.0	13.2	10000	232	222	36.1
	6.0 - 11.0	01A160FHO110Z	21.0	21.0	25.8	35.7	2.5	21.0	16.0	10000	232	222	38.2

Écrou à sertir en aveugle correspondant à l'ancienne désignation H ... FO ... ACIER
 Blind Rivet Nuts corresponding to old designation H ... FO ... STEEL



Écrous à sertir en aveugle Blind Rivet Nuts



Matière : Acier Material : Steel
 Tête : Fraisée Head : Countersunk
 Fût : Cannelé Body : Knurled
 Extrémité du fût : Ouvert Body end : Open Shape

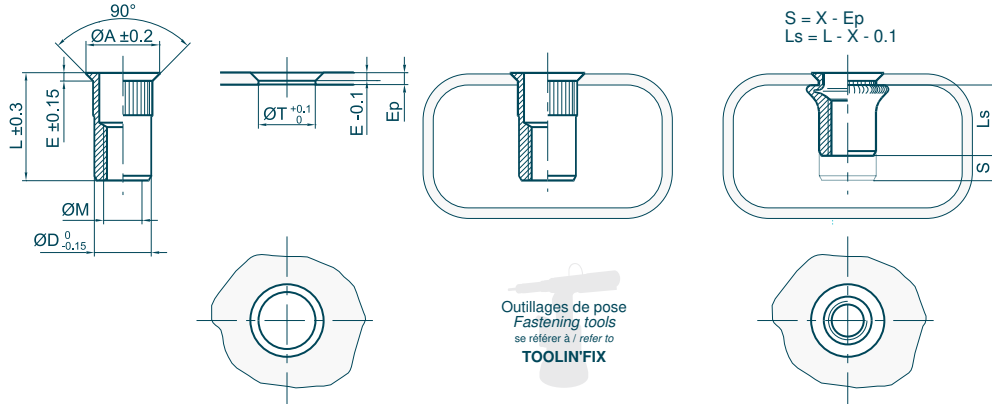

Outillages de pose
Fastening tools
se référer à / refer to
TOOLINFIX

Ø M	Ep		Code	mm ØT	Ø A	L	E	Ø D	X indicative data				kg x1000
	min	max											
M2.5 x 0.45	1.1	1.7	01A025FCO017Z	4.0	5.0	7.0	0.6	4.0	3.0	300	1.0	0.8	0.3
M3 x 0.50	1.1	1.7	01A030FCO017Z	5.0	6.8	7.8	1.0	5.0	2.8	450	1.4	1.0	0.6
	1.1	2.3	01A030FCO023Z	5.0	6.8	8.4	1.0	5.0	3.4	450	1.4	1.0	0.7
	1.8	3.0	01A030FCO030Z	5.0	6.8	9.0	1.0	5.0	4.0	450	1.4	1.0	0.7
	1.1	2.1	01A040FCO021Z	6.0	7.8	10.2	1.0	6.0	3.4	750	3.2	2.1	1.1
M4 x 0.70	1.1	3.0	01A040FCO030Z	6.0	7.8	11.1	1.0	6.0	4.3	750	3.2	2.1	1.1
	1.7	3.7	01A040FCO037Z	6.0	7.8	11.8	1.0	6.0	5.0	750	3.2	2.1	1.2
	1.1	2.5	01A050FCO025Z	7.0	8.8	11.8	1.0	7.0	4.0	1080	6.4	3.2	1.6
	1.5	3.5	01A050FCO035Z	7.0	8.8	12.8	1.0	7.0	5.0	1080	6.4	3.2	1.7
M5 x 0.80	2.5	4.5	01A050FCO045Z	7.0	8.8	13.8	1.0	7.0	6.0	1080	6.4	3.2	1.8
	1.1	2.5	01A060FCO025Z	9.0	10.8	14.3	1.0	9.0	4.4	1800	11.1	6.0	3.6
	1.5	3.5	01A060FCO035Z	9.0	10.8	15.3	1.0	9.0	5.4	1800	11.1	6.0	3.7
	2.5	4.5	01A060FCO045Z	9.0	10.8	16.3	1.0	9.0	6.4	1800	11.1	6.0	3.9
M6 x 1.00	3.5	5.5	01A060FCO055Z	9.0	10.8	17.3	1.0	9.0	7.4	1800	11.1	6.0	4.0
	1.8	3.0	01A080FCO030Z	11.0	13.8	15.8	1.5	11.0	4.9	2950	27	10.5	5.4
	2.2	4.2	01A080FCO042Z	11.0	13.8	17.0	1.5	11.0	6.1	2950	27	10.5	5.7
	3.0	5.0	01A080FCO050Z	11.0	13.8	17.8	1.5	11.0	6.9	2950	27	10.5	5.9
M8 x 1.25	4.5	6.5	01A080FCO065Z	11.0	13.8	19.3	1.5	11.0	8.4	2950	27	10.5	6.2
	1.8	4.0	01A100FCO040Z	13.0	15.8	21.4	1.5	13.0	6.8	4000	53	16.4	9.3
	2.0	5.5	01A100FCO055Z	13.0	15.8	22.9	1.5	13.0	8.3	4000	53	16.4	9.7
	4.0	7.0	01A100FCO070Z	13.0	15.8	24.4	1.5	13.0	9.8	4000	53	16.4	10.1
M10 x 1.50	2.5	4.2	01A120FCO042Z	16.0	19.8	24.3	2.0	16.0	7.3	6100	92	23.5	16.6
	2.5	6.0	01A120FCO060Z	16.0	19.8	26.1	2.0	16.0	9.1	6100	92	23.5	17.3
	3.5	7.6	01A120FCO076Z	16.0	19.8	27.7	2.0	16.0	10.7	6100	92	23.5	18.0
	6.0	9.2	01A120FCO092Z	16.0	19.8	29.3	2.0	16.0	12.3	6100	92	23.5	18.6
M12 x 1.75	1.0	5.0	01A140FCO050Z	18.0	22.8	28.7	2.5	18.0	9.0	7200	148	31.5	24.5
	3.0	7.0	01A140FCO070Z	18.0	22.8	30.6	2.5	18.0	11.0	7200	148	31.5	25.8
	6.0	9.0	01A140FCO090Z	18.0	22.8	32.6	2.5	18.0	13.0	7200	148	31.5	27.1
	3.0	5.7	01A160FCO057Z	21.0	25.8	30.4	2.5	21.0	10.7	10000	232	41	34.2
M16 x 2.00	2.0	8.2	01A160FCO082Z	21.0	25.8	32.9	2.5	21.0	13.2	10000	232	41	36.1
	6.0	11.0	01A160FCO110Z	21.0	25.8	35.7	2.5	21.0	16.0	10000	232	41	38.2

Écrou à sertir en aveugle correspondant à l'ancienne désignation C ... FO ... ACIER
 Blind Rivet Nuts corresponding to old designation C ... FO ... STEEL







Écrous à sertir en aveugle Blind Rivet Nuts

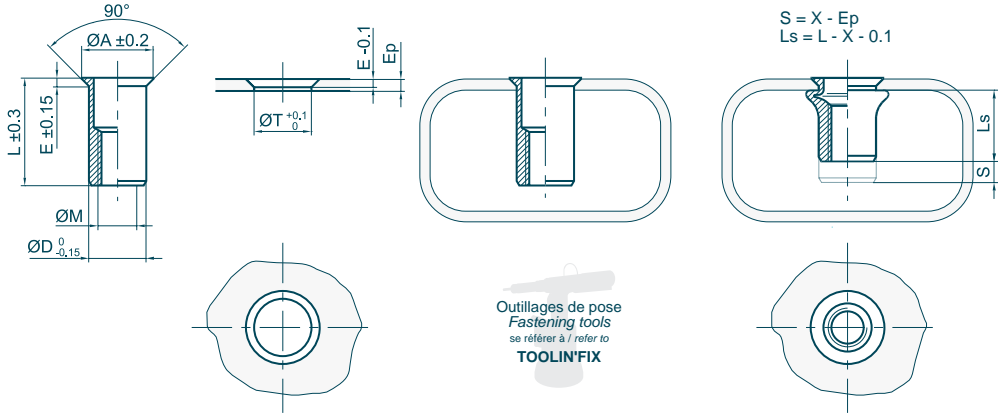

Matière : Inox *Material : Stainless Steel*
 Tête : Fraisée *Head : Countersunk*
 Fût : Cylindrique *Body : Round*
 Extrémité du fût : Ouvert *Body end : Open Shape*



Ø M	Ep		Code	mm ØT	Ø A	L	E	Ø D	X indicative data				
	min	max											
M2.5 x 0.45	1.0 - 1.7		011025FRO017X	4.0	5.0	7.0	0.4	4.0	3.0	325	1.0	0.8	0.3
M3 x 0.50	1.1 - 1.7		011030FRO017X	5.0	6.8	7.3	1.0	5.0	2.9	500	1.4	1.0	0.6
	1.1 - 2.3		011030FRO023X	5.0	6.8	7.9	1.0	5.0	3.5	500	1.4	1.0	0.6
	2.3 - 3.0		011030FRO030X	5.0	6.8	8.5	1.0	5.0	4.1	500	1.4	1.0	0.6
	1.1 - 2.1		011040FRO021X	6.0	7.8	9.2	1.0	6.0	3.4	825	3.2	2.1	1.0
M4 x 0.70	1.8 - 3.0		011040FRO030X	6.0	7.8	10.1	1.0	6.0	4.3	825	3.2	2.1	1.0
	2.5 - 3.7		011040FRO037X	6.0	7.8	10.8	1.0	6.0	5.0	825	3.2	2.1	1.1
	1.1 - 2.5		011050FRO025X	7.0	8.8	10.6	1.0	7.0	4.1	1150	6.4	3.2	1.4
	1.1 - 3.5		011050FRO035X	7.0	8.8	11.6	1.0	7.0	5.1	1150	6.4	3.2	1.5
M5 x 0.80	3.0 - 4.5		011050FRO045X	7.0	8.8	12.6	1.0	7.0	6.1	1150	6.4	3.2	1.6
	1.1 - 2.5		011060FRO025X	9.0	10.8	12.9	1.0	9.0	4.5	1950	11.1	6.0	3.2
	1.1 - 3.5		011060FRO035X	9.0	10.8	13.9	1.0	9.0	5.5	1950	11.1	6.0	3.3
	2.0 - 4.5		011060FRO045X	9.0	10.8	14.9	1.0	9.0	6.5	1950	11.1	6.0	3.5
M6 x 1.00	3.0 - 5.5		011060FRO055X	9.0	10.8	15.9	1.0	9.0	7.5	1950	11.1	6.0	3.6
	1.8 - 3.0		011080FRO030X	11.0	13.8	15.6	1.5	11.0	5.2	3200	27	10.5	5.3
	1.8 - 4.2		011080FRO042X	11.0	13.8	16.8	1.5	11.0	6.4	3200	27	10.5	5.5
	2.5 - 5.0		011080FRO050X	11.0	13.8	17.6	1.5	11.0	7.2	3200	27	10.5	5.8
M8 x 1.25	4.5 - 6.5		011080FRO065X	11.0	13.8	18.8	1.5	11.0	8.7	3200	27	10.5	5.9
	1.8 - 4.0		011100FRO040X	13.0	15.8	19.9	1.5	13.0	7.0	4350	53	16.4	8.5
	2.5 - 5.5		011100FRO055X	13.0	15.8	21.4	1.5	13.0	8.5	4350	53	16.4	8.9
	4.5 - 7.0		011100FRO070X	13.0	15.8	22.9	1.5	13.0	10.0	4350	53	16.4	9.3
M10 x 1.50	2.5 - 4.2		011120FRO042X	16.0	19.8	23.5	2.0	16.0	8.1	6500	92	23.5	15.3
	2.5 - 6.0		011120FRO060X	16.0	19.8	25.3	2.0	16.0	9.9	6500	92	23.5	16.0
	4.0 - 7.6		011120FRO076X	16.0	19.8	26.8	2.0	16.0	11.5	6500	92	23.5	16.7
	7.0 - 9.2		011120FRO092X	16.0	19.8	28.4	2.0	16.0	13.1	6500	92	23.5	17.7
M12 x 1.75	3.0 - 5.0		011140FRO050X	18.0	22.8	26.7	2.5	18.0	9.3	7800	148	31.5	22.6
	4.0 - 7.0		011140FRO070X	18.0	22.8	28.7	2.5	18.0	11.3	7800	148	31.5	23.9
	7.0 - 9.0		011140FRO090X	18.0	22.8	30.7	2.5	18.0	13.3	7800	148	31.5	25.2
M14 x 2.00	3.0 - 5.7		011160FRO057X	21.0	25.8	28.0	2.5	21.0	10.9	10500	232	41	31.0
	3.5 - 8.2		011160FRO082X	21.0	25.8	30.5	2.5	21.0	13.4	10500	232	41	32.9
	7.0 - 11.0		011160FRO110X	21.0	25.8	33.3	2.5	21.0	16.2	10500	232	41	35.2

Écrou à sertir en aveugle correspondant à l'ancienne désignation M ... FO ... INOX
 Blind Rivet Nuts corresponding to old designation M ... FO ... STAINLESS STEEL

Catalog found by Google search and provided by: RIVET NUT USA™ RivetNutUSA.com | Sales@RivetNutUSA.com | 800.236.3200

Écrous à sertir en aveugle Blind Rivet Nuts



Matière : Inox Material : Stainless Steel
 Tête : Fraisée Head : Countersunk
 Fût : Hexagonal Body : Hexagonal
 Extrémité du fût : Ouvert Body end : Open Shape

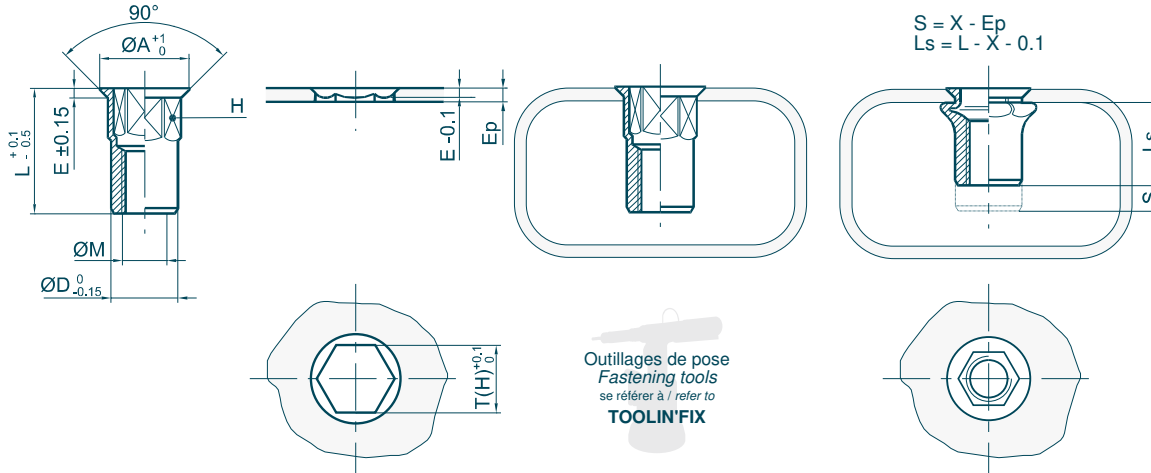

Ø M	Ep min - max	Code	H	mm T(H)	Ø A	L	E	Ø D	X indicative data	daN			kg x1000
										daN	N.m	N.m	
M2.5 x 0.45	1.0 - 1.7	01I025FHO017X	4.0	4.0	5.0	7.0	0.6	4.0	3.0	325	1.0	1.0	0.3
M3 x 0.50	1.1 - 1.7	01I030FHO017X	5.0	5.0	6.8	7.3	1.0	5.0	2.9	500	1.4	1.3	0.6
	1.1 - 2.3	01I030FHO023X	5.0	5.0	6.8	7.9	1.0	5.0	3.5	500	1.4	1.3	0.6
	2.3 - 3.0	01I030FHO030X	5.0	5.0	6.8	8.5	1.0	5.0	4.1	500	1.4	1.3	0.6
M4 x 0.70	1.1 - 2.1	01I040FHO021X	6.0	6.0	7.8	9.2	1.0	6.0	3.4	825	3.2	3.1	1.0
	1.8 - 3.0	01I040FHO030X	6.0	6.0	7.8	10.1	1.0	6.0	4.3	825	3.2	3.1	1.0
	2.5 - 3.7	01I040FHO037X	6.0	6.0	7.8	10.8	1.0	6.0	5.0	825	3.2	3.1	1.1
	1.1 - 2.5	01I050FHO025X	7.0	7.0	8.8	10.6	1.0	7.0	4.1	1150	6.4	6.1	1.4
M5 x 0.80	1.5 - 3.5	01I050FHO035X	7.0	7.0	8.8	11.6	1.0	7.0	5.1	1150	6.4	6.1	1.5
	3.0 - 4.5	01I050FHO045X	7.0	7.0	8.8	12.6	1.0	7.0	6.1	1150	6.4	6.1	1.6
	1.1 - 2.5	01I060FHO025X	9.0	9.0	10.8	12.9	1.0	9.0	4.5	1950	11.1	10.6	3.2
M6 x 1.00	1.5 - 3.5	01I060FHO035X	9.0	9.0	10.8	13.9	1.0	9.0	5.5	1950	11.1	10.6	3.3
	2.5 - 4.5	01I060FHO045X	9.0	9.0	10.8	14.9	1.0	9.0	6.5	1950	11.1	10.6	3.5
	3.5 - 5.5	01I060FHO055X	9.0	9.0	10.8	15.9	1.0	9.0	7.5	1950	11.1	10.6	3.6
	1.8 - 3.0	01I080FHO030X	11.0	11.0	13.8	15.6	1.5	11.0	5.2	3200	27	25.8	5.3
M8 x 1.25	2.2 - 4.2	01I080FHO042X	11.0	11.0	13.8	16.8	1.5	11.0	6.4	3200	27	25.8	5.5
	3.0 - 5.0	01I080FHO050X	11.0	11.0	13.8	17.6	1.5	11.0	7.2	3200	27	25.8	5.8
	4.5 - 6.5	01I080FHO065X	11.0	11.0	13.8	18.8	1.5	11.0	8.7	3200	27	25.8	5.9
	1.8 - 4.0	01I100FHO040X	13.0	13.0	15.8	19.9	1.5	13.0	7.0	4350	53	51	8.5
M10 x 1.50	2.5 - 5.5	01I100FHO055X	13.0	13.0	15.8	21.4	1.5	13.0	8.5	4350	53	51	8.9
	4.5 - 7.0	01I100FHO070X	13.0	13.0	15.8	22.9	1.5	13.0	10.0	4350	53	51	9.3
	2.5 - 4.2	01I120FHO042X	16.0	16.0	19.8	23.5	2.0	16.0	8.1	6500	92	88	15.3
M12 x 1.75	2.5 - 6.0	01I120FHO060X	16.0	16.0	19.8	25.3	2.0	16.0	9.9	6500	92	88	16.0
	4.0 - 7.6	01I120FHO076X	16.0	16.0	19.8	26.8	2.0	16.0	11.5	6500	92	88	16.7
	7.0 - 9.2	01I120FHO092X	16.0	16.0	19.8	28.4	2.0	16.0	13.1	6500	92	88	17.7
	3.0 - 5.0	01I140FHO050X	18.0	18.0	22.8	26.7	2.5	18.0	9.3	7800	148	142	22.6
M14 x 2.00	4.0 - 7.0	01I140FHO070X	18.0	18.0	22.8	28.7	2.5	18.0	11.3	7800	148	142	23.9
	7.0 - 9.0	01I140FHO090X	18.0	18.0	22.8	30.7	2.5	18.0	13.3	7800	148	142	25.2
	3.0 - 5.7	01I160FHO057X	21.0	21.0	25.8	28.0	2.5	21.0	10.9	10500	232	222	31.0
M16 x 2.00	3.5 - 8.2	01I160FHO082X	21.0	21.0	25.8	30.5	2.5	21.0	13.4	10500	232	222	32.9
	7.0 - 11.0	01I160FHO110X	21.0	21.0	25.8	33.3	2.5	21.0	16.2	10500	232	222	35.2

Écrou à sertir en aveugle correspondant à l'ancienne désignation H ... FO ... INOX
 Blind Rivet Nuts corresponding to old designation H ... FO ... STAINLESS STEEL

Catalog found by Google search and provided by: RIVET NUT USA™ RivetNutUSA.com | Sales@RivetNutUSA.com | 800.236.3200

LA CLUSIENNE-CLUFIX : Solutions et composants d'assemblage - Fastening solutions

FPC000033-2011.A

313, rue Louis ARMAND - BP 220 - Z.I. des grands prés - 74304 Cluses Cedex France - Tel. +33 (0)4 50 98 13 13 - Fax. +33 (0)4 50 98 28 89 - www.laclusienne.com

LA CLUSIENNE WARRANTS THAT THE PRODUCTS SOLD WILL BE FREE FROM DEFECTS IN MATERIAL AND WORKMANSHIP AND MEET THEIR APPLICABLE PRODUCT SPECIFICATIONS LA CLUSIENNE MAKES NO WARRANTY THAT THE PRODUCTS WILL BE MERCHANTABLE OR FIT FOR ANY PARTICULAR PURPOSE.

Écrous à sertir en aveugle Blind Rivet Nuts



Matière : Inox Material : Stainless Steel
 Tête : Affleurante Head : Flush
 Fût : Hexagonal Body : Hexagonal
 Extrémité du fût : Ouvert Body end : Open Shape

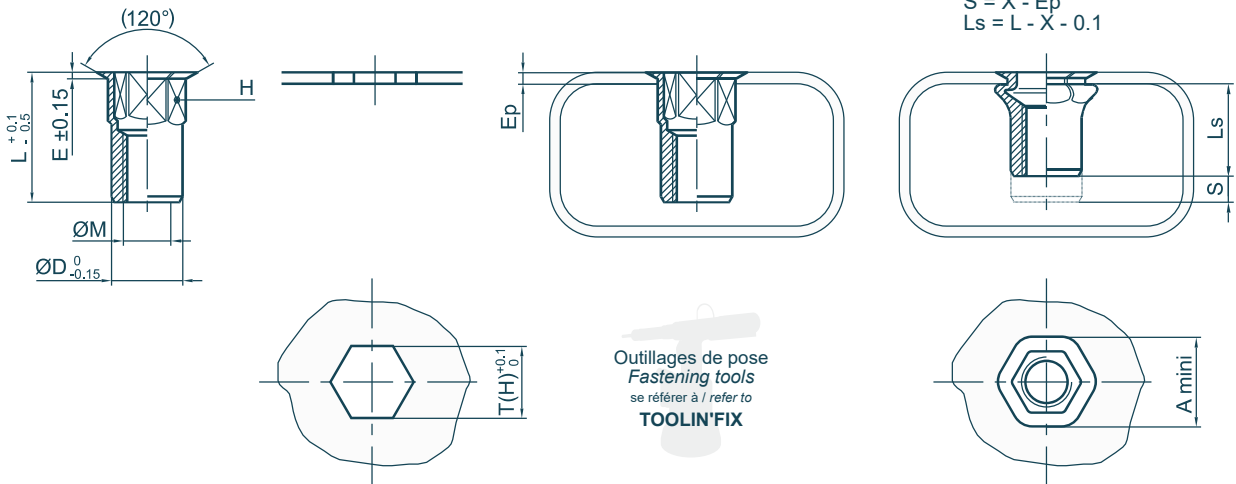

Ø M	Ep min - max	Code	H	mm T(H)	A	L	E	Ø D	X indicative data	daN			kg x1000
										daN	N.m	N.m	
M2.5 x 0.45	0.0 - 1.1	011025AHO011X	4.0	4.0	4.5	6.4	0.3	4.0	2.4	325	1.0	1.0	0.3
	1.0 - 1.7	011025AHO017X	4.0	4.0	4.5	7.1	0.3	4.0	3.0	325	1.0	1.0	0.3
M3 x 0.50	0.0 - 1.1	011030AHO011X	5.0	5.0	5.7	6.7	0.3	5.0	2.3	500	1.4	1.3	0.5
	1.0 - 2.3	011030AHO023X	5.0	5.0	5.7	7.9	0.3	5.0	3.4	500	1.4	1.3	0.6
	2.3 - 3.2	011030AHO032X	5.0	5.0	5.7	9.1	0.3	5.0	4.7	500	1.4	1.3	0.6
	3.2 - 4.1	011030AHO041X	5.0	5.0	5.7	10.0	0.3	5.0	5.7	500	1.4	1.3	0.6
M4 x 0.70	0.0 - 1.3	011040AHO013X	6.0	6.0	6.7	8.4	0.3	6.0	2.6	825	3.2	3.1	0.9
	1.0 - 2.3	011040AHO023X	6.0	6.0	6.7	9.7	0.3	6.0	3.6	825	3.2	3.1	0.9
	1.8 - 3.0	011040AHO030X	6.0	6.0	6.7	9.9	0.3	6.0	4.3	825	3.2	3.1	0.9
	2.9 - 3.7	011040AHO037X	6.0	6.0	6.7	11.1	0.3	6.0	5.0	825	3.2	3.1	0.9
	3.0 - 4.2	011040AHO042X	6.0	6.0	6.7	12.1	0.3	6.0	5.5	825	3.2	3.1	1.0
	4.2 - 5.5	011040AHO055X	6.0	6.0	6.7	13.6	0.3	6.0	6.8	825	3.2	3.1	1.1
M5 x 0.80	0.0 - 1.5	011050AHO015X	7.0	7.0	7.9	9.6	0.4	7.0	3.1	1150	6.4	6.1	1.3
	0.5 - 2.5	011050AHO025X	7.0	7.0	7.9	10.6	0.4	7.0	4.1	1150	6.4	6.1	1.3
	1.5 - 3.5	011050AHO035X*	7.0	7.0	7.7	12.9	0.35	7.0	4.9	1150	6.4	6.1	1.5
	1.5 - 3.5	011050AHO035XD	7.0	7.0	7.9	12.9	0.4	7.0	4.9	1150	6.4	6.1	1.5
	3.0 - 4.5	011050AHO045X	7.0	7.0	7.9	12.6	0.4	7.0	6.1	1150	6.4	6.1	1.5
M6 x 1.00	4.5 - 5.5	011050AHO055X	7.0	7.0	7.9	13.6	0.4	7.0	7.1	1150	6.4	6.1	1.55
	0.0 - 1.5	011060AHO015X	9.0	9.0	9.9	11.9	0.4	9.0	3.5	1950	11.1	10.6	2.9
	1.5 - 3.5	011060AHO035X*	9.0	9.0	9.7	13.9	0.35	9.0	5.8	1950	11.1	10.6	3.2
	1.5 - 3.5	011060AHO035XD	9.0	9.0	9.9	13.9	0.4	9.0	5.8	1950	11.1	10.6	3.2
	2.5 - 4.5	011060AHO045X	9.0	9.0	9.9	14.9	0.4	9.0	6.5	1950	11.1	10.6	3.4
	3.5 - 5.5	011060AHO055X	9.0	9.0	9.9	15.9	0.4	9.0	7.5	1950	11.1	10.6	3.5
M8 x 1.25	5.0 - 6.5	011060AHO065X	9.0	9.0	9.9	16.8	0.4	9.0	8.5	1950	11.1	10.6	3.6
	0.0 - 1.8	011080AHO018X	11.0	11.0	11.9	14.4	0.4	11.0	4.0	3200	27	25.8	4.7
	1.0 - 3.0	011080AHO030X	11.0	11.0	11.9	15.6	0.4	11.0	5.2	3200	27	25.8	5.0
	2.2 - 4.2	011080AHO042X	11.0	11.0	11.9	16.8	0.4	11.0	6.4	3200	27	25.8	5.2
	3.0 - 5.0	011080AHO050X*	11.0	11.0	11.7	17.4	0.35	11.0	7.2	3200	27	25.8	5.4
	3.0 - 5.0	011080AHO050XD	11.0	11.0	11.9	17.4	0.4	11.0	7.2	3200	27	25.8	5.4
	4.5 - 6.5	011080AHO065X	11.0	11.0	11.9	19.1	0.4	11.0	8.7	3200	27	25.8	5.7
M10 x 1.50	6.5 - 8.5	011080AHO085X	11.0	11.0	11.9	21.1	0.4	11.0	10.5	3200	27	25.8	5.9
	0.0 - 3.2	011100AHO032X	13.0	13.0	14.4	19.1	0.6	13.0	6.2	4350	53	51	7.9
	2.5 - 5.5	011100AHO055X	13.0	13.0	14.4	21.4	0.6	13.0	8.5	4350	53	51	8.4
	3.5 - 6.5	011100AHO065X	13.0	13.0	14.4	22.4	0.6	13.0	9.5	4350	53	51	8.5
	5.5 - 7.5	011100AHO075X	13.0	13.0	14.4	23.4	0.6	13.0	10.5	4350	53	51	8.5
M12 x 1.75	6.5 - 8.5	011100AHO085X	13.0	13.0	14.4	24.4	0.6	13.0	11.5	4350	53	51	8.6
	0.0 - 4.2	011120AHO042X	16.0	16.0	17.4	23.0	0.6	16.0	8.1	6500	92	88	14.3
	2.5 - 6.0	011120AHO060X	16.0	16.0	17.4	24.4	0.6	16.0	9.9	6500	92	88	15.1
	4.0 - 7.6	011120AHO076X	16.0	16.0	17.4	26.0	0.6	16.0	11.5	6500	92	88	15.6
M14 x 2.00	7.0 - 9.2	011120AHO092X	16.0	16.0	17.4	27.6	0.6	16.0	13.1	6500	92	88	16.3
	0.0 - 3.0	011140AHO030X	18.0	18.0	19.35	24.6	0.6	18.0	7.3	7800	148	142	20.1
	2.0 - 5.0	011140AHO050X	18.0	18.0	19.35	26.6	0.6	18.0	9.3	7800	148	142	21.3
	4.0 - 7.0	011140AHO070X	18.0	18.0	19.35	28.6	0.6	18.0	11.3	7800	148	142	22.5
M16 x 2.00	7.0 - 9.0	011140AHO090X	18.0	18.0	19.35	30.6	0.6	18.0	13.3	7800	148	142	23.8
	0.0 - 3.2	011160AHO032X	21.0	21.0	22.35	25.5	0.6	21.0	8.4	10500	232	222	27.5
	1.0 - 5.7	011160AHO057X	21.0	21.0	22.35	28.0	0.6	21.0	10.9	10500	232	222	29.4
	3.5 - 8.2	011160AHO082X	21.0	21.0	22.35	30.5	0.6	21.0	13.4	10500	232	222	31.3
	7.0 - 11.0	011160AHO110X	21.0	21.0	22.35	33.3	0.6	21.0	16.2	10500	232	222	33.2

* = Cold headed product Écrou à sertir en aveugle correspondant à l'ancienne désignation H ... fO ... INOX
 Blind Rivet Nuts corresponding to old designation H ... fO ... STAINLESS STEEL



Écrous à sertir en aveugle Blind Rivet Nuts



Matière : Inox	Material : Stainless Steel
Tête : Cylindrique	Head : Flange
Fût : Hexagonal	Body : Hexagonal
Extrémité du fût : Ouvert	Body end : Open Shape

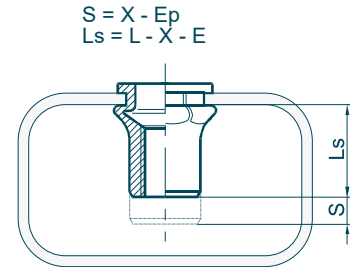
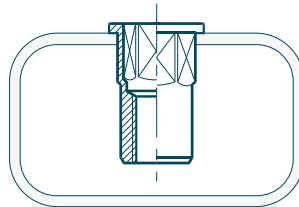
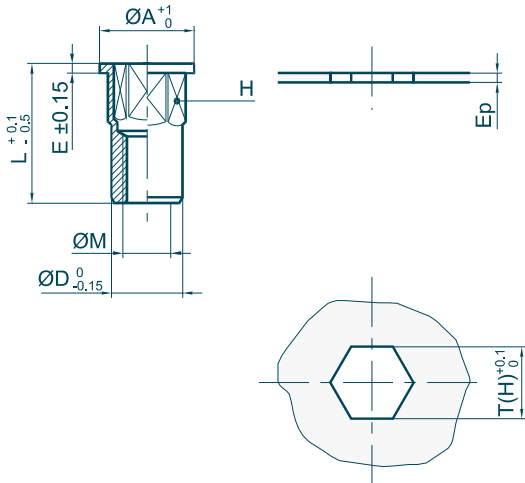

Outillages de pose
Fastening tools
se référer à / refer to
TOOLIN'FIX

Ø M	Ep min - max	Code	H	mm T(H)	Ø A	L	E	Ø D	X indicative data				
M2.5 x 0.45	0.0 - 1.1	011025CHO011X	4.0	4.0	6.0	6.9	0.6	4.0	2.4	325	1.0	1.0	0.4
	1.0 - 1.7	011025CHO017X	4.0	4.0	6.0	7.5	0.6	4.0	3.0	325	1.0	1.0	0.4
M3 x 0.50	0.0 - 1.1	011030CHO011X	5.0	5.0	7.0	7.4	0.8	5.0	2.3	500	1.4	1.3	0.6
	0.0 - 1.7	011030CHO017X	5.0	5.0	7.0	8.0	0.8	5.0	2.9	500	1.4	1.3	0.7
	1.0 - 2.3	011030CHO023X	5.0	5.0	7.0	8.6	0.8	5.0	3.5	500	1.4	1.3	0.7
M4 x 0.70	2.3 - 3.0	011030CHO030X	5.0	5.0	7.0	9.2	0.8	5.0	4.1	500	1.4	1.3	0.7
	0.0 - 1.3	011040CHO013X	6.0	6.0	8.0	9.1	0.8	6.0	2.6	825	3.2	3.1	1.0
	0.8 - 2.1	011040CHO021X	6.0	6.0	8.0	9.8	0.8	6.0	3.3	825	3.2	3.1	1.1
	1.8 - 3.0	011040CHO030X	6.0	6.0	8.0	10.7	0.8	6.0	4.3	825	3.2	3.1	1.1
M5 x 0.80	2.5 - 3.7	011040CHO037X	6.0	6.0	8.0	11.5	0.8	6.0	5.0	825	3.2	3.1	1.2
	0.0 - 1.5	011050CHO015X	7.0	7.0	9.0	10.5	1.0	7.0	3.1	1150	6.4	6.1	1.5
	0.5 - 2.5	011050CHO025X	7.0	7.0	9.0	11.5	1.0	7.0	4.1	1150	6.4	6.1	1.6
	1.5 - 3.5	011050CHO035X	7.0	7.0	9.0	12.2	1.0	7.0	5.1	1150	6.4	6.1	1.7
	3.0 - 4.5	011050CHO045X	7.0	7.0	9.0	13.5	1.0	7.0	6.1	1150	6.4	6.1	1.8
M6 x 1.00	8.5 - 10.5	011050CHO105X	7.0	7.0	9.0	19.5	1.0	7.0	12.1	1150	6.4	6.1	2
	0.0 - 1.5	011060CHO015X	9.0	9.0	11.0	13.0	1.2	9.0	3.5	1950	11.1	10.6	3.4
	0.5 - 2.5	011060CHO025X	9.0	9.0	11.0	14.0	1.2	9.0	4.5	1950	11.1	10.6	3.5
	1.5 - 3.5	011060CHO035X	9.0	9.0	11.0	15.0	1.2	9.0	5.5	1950	11.1	10.6	3.7
	2.5 - 4.5	011060CHO045X	9.0	9.0	11.0	16.1	1.2	9.0	6.5	1950	11.1	10.6	3.9
	3.5 - 5.5	011060CHO055X	9.0	9.0	11.0	17.1	1.2	9.0	7.5	1950	11.1	10.6	4.0
M8 x 1.25	8.5 - 10.5	011060CHO105X	9.0	9.0	11.0	22.1	1.2	9.0	12.5	1950	11.1	10.6	4.5
	0.0 - 1.8	011080CHO018X	11.0	11.0	14.0	15.7	1.5	11.0	4.0	3200	27	25.8	5.7
	1.0 - 3.0	011080CHO030X	11.0	11.0	14.0	16.9	1.5	11.0	5.2	3200	27	25.8	5.9
	2.2 - 4.2	011080CHO042X	11.0	11.0	14.0	18.1	1.5	11.0	6.4	3200	27	25.8	6.2
	3.0 - 5.0	011080CHO050X	11.0	11.0	14.0	18.9	1.5	11.0	7.2	3200	27	25.8	6.3
	4.5 - 6.5	011080CHO065X	11.0	11.0	14.0	20.4	1.5	11.0	8.7	3200	27	25.8	6.7
	5.5 - 7.5	011080CHO075X	11.0	11.0	14.0	21.4	1.5	11.0	9.7	3200	27	25.8	6.8
	9 - 11	011080CHO110X	11.0	11.0	14.0	24.9	1.5	11.0	13.2	3200	27	25.8	7.2
M10 x 1.50	0.0 - 2.5	011100CHO025X	13.0	13.0	16.0	19.8	1.5	13.0	5.5	4350	53	51	8.9
	1.0 - 4.0	011100CHO040X	13.0	13.0	16.0	21.3	1.5	13.0	7.0	4350	53	51	9.4
	2.5 - 5.5	011100CHO055X	13.0	13.0	16.0	22.8	1.5	13.0	8.5	4350	53	51	9.8
	4.5 - 7.0	011100CHO070X	13.0	13.0	16.0	24.3	1.5	13.0	10.0	4350	53	51	10.2
	5 - 7.5	011100CHO075X	13.0	13.0	16.0	24.8	1.5	13.0	10.5	4350	53	51	10.2
M12 x 1.75	0.0 - 4.2	011120CHO042X	16.0	16.0	20.0	23.3	1.7	16.0	8.1	6500	92	88	15.2
	2.5 - 6.0	011120CHO060X	16.0	16.0	20.0	26.0	1.7	16.0	9.9	6500	92	88	16.6
	4.0 - 7.6	011120CHO076X	16.0	16.0	20.0	28.5	1.7	16.0	11.5	6500	92	88	18.1
	7.0 - 9.2	011120CHO092X	16.0	16.0	20.0	30.1	1.7	16.0	13.1	6500	92	88	18.7
M14 x 2.00	0.0 - 3.0	011140CHO030X	18.0	18.0	23.0	26.9	2.0	18.0	7.3	7800	148	142	23.7
	2.0 - 5.0	011140CHO050X	18.0	18.0	23.0	28.6	2.0	18.0	9.3	7800	148	142	24.9
	4.0 - 7.0	011140CHO070X	18.0	18.0	23.0	30.6	2.0	18.0	11.3	7800	148	142	26.2
	7.0 - 9.0	011140CHO090X	18.0	18.0	23.0	32.6	2.0	18.0	13.3	7800	148	142	27.5
M16 x 2.00	0.0 - 3.2	011160CHO032X	21.0	21.0	26.0	28.0	2.5	21.0	8.4	10500	232	222	33.1
	1.0 - 5.7	011160CHO057X	21.0	21.0	26.0	30.5	2.5	21.0	10.9	10500	232	222	35.0
	3.5 - 8.2	011160CHO082X	21.0	21.0	26.0	33.0	2.5	21.0	13.4	10500	232	222	36.9
	7.0 - 11.0	011160CHO110X	21.0	21.0	26.0	35.8	2.5	21.0	16.2	10500	232	222	39.0

Écrou à sertir en aveugle correspondant à l'ancienne désignation H ... CO ... INOX
Blind Rivet Nuts corresponding to old designation H ... CO ... STAINLESS STEEL

Écrous à sertir en aveugle
Blind Rivet Nuts



Material : 316L Stainless Steel

Matière : Inox 316L

Head : Flush

Tête : Affleurante

Body : Round

Fût : Cylindrique



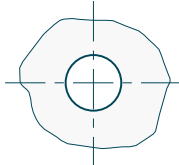
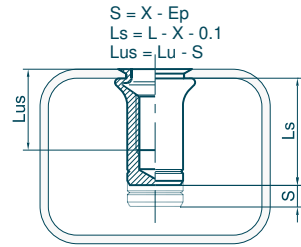
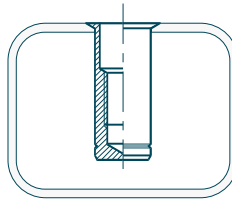
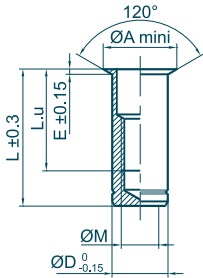

Body end : Closed End

Extrémité du fût : Borgne

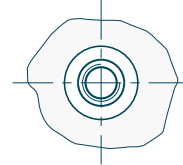

Outillages de pose
Fastening tools
se référer à / refer to
TOOLIN'FIX



Ø M	Ep		Code	mm ØT	Ø A	L	L.u	E	Ø D	X indicative data				
	min	max												
M2.5 x 0.45	0.0 - 1.1		01M025ARB011X	4.0	4.6	9.6	5.5	0.3	4.0	2.4	325	1.0	0.8	0.5
	1.0 - 1.7		01M025ARB017X	4.0	4.6	10.3	6.5	0.3	4.0	3.0	325	1.0	0.8	0.6
M3 x 0.50	0.0 - 1.1		01M030ARB011X	5.0	5.8	10.7	6.7	0.3	5.0	2.3	500	1.4	1.0	1.0
	1.0 - 2.3		01M030ARB023X	5.0	5.8	11.8	7.8	0.3	5.0	3.4	500	1.4	1.0	1.0
	2.3 - 3.2		01M030ARB032X	5.0	5.8	13.1	9.1	0.3	5.0	4.7	500	1.4	1.0	1.1
	3.2 - 4.1		01M030ARB041X	5.0	5.8	14.0	10.0	0.3	5.0	5.7	500	1.4	1.0	1.1
M4 x 0.70	0.0 - 1.3		01M040ARB013X	6.0	6.8	14.4	8.0	0.3	6.0	2.6	825	3.2	2.1	1.8
	1.0 - 2.3		01M040ARB023X	6.0	6.8	15.0	8.7	0.3	6.0	3.6	825	3.2	2.1	1.9
	1.8 - 3.0		01M040ARB030X	6.0	6.8	15.9	9.5	0.3	6.0	4.3	825	3.2	2.1	1.9
	3.0 - 4.2		01M040ARB042X	6.0	6.8	17.0	10.6	0.3	6.0	5.5	825	3.2	2.1	2.0
	4.2 - 5.5		01M040ARB055X	6.0	6.8	18.3	11.9	0.3	6.0	6.8	825	3.2	2.1	2.0
	0.0 - 1.5		01M050ARB015X	7.0	8.0	16.5	9.5	0.4	7.0	3.1	1150	6.4	3.2	2.7
M5 x 0.80	0.0 - 2.5		01M050ARB025X	7.0	8.0	17.4	10.4	0.4	7.0	4.1	1150	6.4	3.2	2.8
	1.0 - 3.5		01M050ARB035X	7.0	8.0	18.5	11.5	0.4	7.0	5.1	1150	6.4	3.2	2.9
	3.0 - 4.5		01M050ARB045X	7.0	8.0	19.5	12.5	0.4	7.0	6.1	1150	6.4	3.2	2.9
	0.0 - 1.5		01M060ARB015X	9.0	10.0	19.9	11.5	0.4	9.0	3.5	1950	11.1	6.0	5.9
	1.0 - 3.5		01M060ARB035X	9.0	10.0	21.9	13.5	0.4	9.0	5.5	1950	11.1	6.0	6.2
M6 x 1.00	2.0 - 4.5		01M060ARB045X	9.0	10.0	22.9	14.5	0.4	9.0	6.5	1950	11.1	6.0	6.3
	3.0 - 5.5		01M060ARB055X	9.0	10.0	23.9	15.5	0.4	9.0	7.5	1950	11.1	6.0	6.5
	4.5 - 6.5		01M060ARB065X	9.0	10.0	24.9	16.5	0.4	9.0	8.5	1950	11.1	6.0	6.6
	0.0 - 1.8		01M080ARB018X	11.0	12.0	23.6	14.3	0.4	11.0	4.0	3200	27	10.5	9.6
	0.5 - 3.0		01M080ARB030X	11.0	12.0	24.8	15.5	0.4	11.0	5.2	3200	27	10.5	10.0
	1.8 - 4.2		01M080ARB042X	11.0	12.0	26.0	16.7	0.4	11.0	6.4	3200	27	10.5	10.2
M8 x 1.25	2.5 - 5.0		01M080ARB050X	11.0	12.0	26.8	17.5	0.4	11.0	7.2	3200	27	10.5	10.3
	4.5 - 6.5		01M080ARB065X	11.0	12.0	28.3	19.0	0.4	11.0	8.7	3200	27	10.5	10.5
	0.0 - 3.2		01M100ARB032X	13.0	14.5	30.9	19.9	0.6	13.0	6.2	4350	53	16.4	15.9
	2.5 - 5.5		01M100ARB055X	13.0	14.5	33.4	22.0	0.6	13.0	8.5	4350	53	16.4	16.6
	3.5 - 6.5		01M100ARB065X	13.0	14.5	34.4	23.0	0.6	13.0	9.5	4350	53	16.4	16.8
M10 x 1.50	5.5 - 7.5		01M100ARB075X	13.0	14.5	35.4	24.0	0.6	13.0	10.5	4350	53	16.4	16.9
	0.0 - 4.2		01M120ARB042X	16.0	17.5	36.0	23.7	0.6	16.0	8.1	6500	92	23.5	27.0
	2.5 - 6.0		01M120ARB060X	16.0	17.5	36.3	24.0	0.6	16.0	9.9	6500	92	23.5	27.8
	4.0 - 7.6		01M120ARB076X	16.0	17.5	38.3	27.0	0.6	16.0	11.5	6500	92	23.5	28.0
	7.0 - 9.2		01M120ARB092X	16.0	17.5	39.6	28.3	0.6	16.0	13.1	6500	92	23.5	28.7
	0.0 - 3.0		01M140ARB030X	18.0	19.5	39.4	25.4	0.6	18.0	7.3	7800	148	31.5	38.9
M12 x 1.75	2.0 - 5.0		01M140ARB050X	18.0	19.5	41.4	27.4	0.6	18.0	9.3	7800	148	31.5	40.1
	4.0 - 7.0		01M140ARB070X	18.0	19.5	43.6	29.6	0.6	18.0	11.3	7800	148	31.5	41.4
	7.0 - 9.0		01M140ARB090X	18.0	19.5	45.7	31.7	0.6	18.0	13.3	7800	148	31.5	42.7
	0.0 - 3.2		01M160ARB032X	21.0	22.5	41.9	25.0	0.6	21.0	8.4	10500	232	41	56.0
	1.0 - 5.7		01M160ARB057X	21.0	22.5	44.4	27.5	0.6	21.0	10.9	10500	232	41	57.9
M16 x 2.00	3.5 - 8.2		01M160ARB082X	21.0	22.5	46.9	30.0	0.6	21.0	13.4	10500	232	41	59.8
	7.0 - 11.0		01M160ARB110X	21.0	22.5	49.7	32.5	0.6	21.0	16.2	10500	232	41	62.2

Écrou à sertir en aveugle correspondant à l'ancienne désignation M ... fB ... INOX MOLYBDENE

Blind Rivet Nuts corresponding to old designation M ... fB ... MOLYBDENUM STAINLESS STEEL



Écrous à sertir en aveugle Blind Rivet Nuts

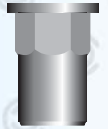

Material : 316L Stainless Steel Matière : Inox 316L
 Head : Flange Tête : Cylindrique
 Body : Hexagonal Fût : Hexagonal
 Body end : Closed End Extrémité du fût : Borgne

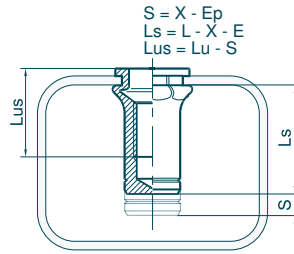
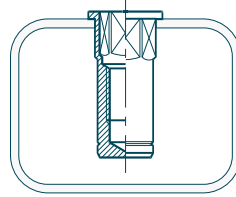
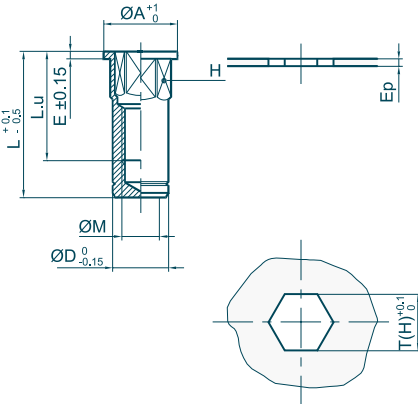

Outillages de pose
Fastening tools
se référer à / refer to
TOOLIN'FIX

Ø M	Ep		Code	H	mm		Ø A	L	Lu	E	Ø D	X	indicative data			kg x1000
	min	max			T(H)	daN							N.m	N.m		
M2.5 x 0.45	0.0 - 1.1	0.1	01M025CHB011X	4.0	4.0	4.0	6.0	10.1	6.0	0.6	4.0	2.4	325	1.0	1.0	0.6
	1.0 - 1.7	0.1	01M025CHB017X	4.0	4.0	6.0	10.8	7.0	0.6	4.0	3.0	325	1.0	1.0	0.6	
M3 x 0.50	0.0 - 1.1	0.1	01M030CHB011X	5.0	5.0	7.0	11.4	8.0	0.8	5.0	2.3	500	1.4	1.3	1.1	
	0.0 - 1.7	0.1	01M030CHB017X	5.0	5.0	7.0	12.0	8.5	0.8	5.0	2.9	500	1.4	1.3	1.2	
	1.0 - 2.3	0.1	01M030CHB023X	5.0	5.0	7.0	12.6	9.0	0.8	5.0	3.5	500	1.4	1.3	1.2	
M4 x 0.70	2.3 - 3.0	0.1	01M030CHB030X	5.0	5.0	7.0	13.1	9.4	0.8	5.0	4.1	500	1.4	1.3	1.2	
	0.0 - 1.3	0.1	01M040CHB013X	6.0	6.0	8.0	14.8	9.0	0.8	6.0	2.6	825	3.2	3.1	2.0	
	0.8 - 2.1	0.1	01M040CHB021X	6.0	6.0	8.0	15.5	9.4	0.8	6.0	3.3	825	3.2	3.1	2.0	
	1.8 - 3.0	0.1	01M040CHB030X	6.0	6.0	8.0	16.5	10.6	0.8	6.0	4.3	825	3.2	3.1	2.0	
	2.5 - 3.7	0.1	01M040CHB037X	6.0	6.0	8.0	17.2	11.3	0.8	6.0	5.0	825	3.2	3.1	2.1	
M5 x 0.80	0.0 - 1.5	0.1	01M050CHB015X	7.0	7.0	9.0	17.0	10.0	1.0	7.0	3.1	1150	6.4	6.1	2.9	
	0.5 - 2.5	0.1	01M050CHB025X	7.0	7.0	9.0	18.0	11.0	1.0	7.0	4.1	1150	6.4	6.1	3.0	
	1.5 - 3.5	0.1	01M050CHB035X	7.0	7.0	9.0	19.0	12.0	1.0	7.0	5.1	1150	6.4	6.1	3.0	
	3.0 - 4.5	0.1	01M050CHB045X	7.0	7.0	9.0	20.0	13.0	1.0	7.0	6.1	1150	6.4	6.1	3.1	
M6 x 1.00	0.0 - 1.5	0.1	01M060CHB015X	9.0	9.0	11.0	21.0	13.0	1.2	9.0	3.5	1950	11.1	10.6	6.3	
	0.5 - 2.5	0.1	01M060CHB025X	9.0	9.0	11.0	22.0	13.6	1.2	9.0	4.5	1950	11.1	10.6	6.5	
	1.5 - 3.5	0.1	01M060CHB035X	9.0	9.0	11.0	23.0	14.5	1.2	9.0	5.5	1950	11.1	10.6	6.6	
	2.5 - 4.5	0.1	01M060CHB045X	9.0	9.0	11.0	23.9	15.4	1.2	9.0	6.5	1950	11.1	10.6	6.7	
	3.5 - 5.5	0.1	01M060CHB055X	9.0	9.0	11.0	25.0	16.5	1.2	9.0	7.5	1950	11.1	10.6	6.9	
M8 x 1.25	0.0 - 1.8	0.1	01M080CHB018X	11.0	11.0	14.0	24.4	15.5	1.5	11.0	4.0	3200	27	25.8	10.1	
	1.0 - 3.0	0.1	01M080CHB030X	11.0	11.0	14.0	25.6	17.3	1.5	11.0	5.2	3200	27	25.8	10.4	
	2.2 - 4.2	0.1	01M080CHB042X	11.0	11.0	14.0	26.8	17.9	1.5	11.0	6.4	3200	27	25.8	10.6	
	3.0 - 5.0	0.1	01M080CHB050X	11.0	11.0	14.0	27.6	18.7	1.5	11.0	7.2	3200	27	25.8	10.9	
	4.5 - 6.5	0.1	01M080CHB065X	11.0	11.0	14.0	29.1	20.2	1.5	11.0	8.7	3200	27	25.8	11.1	
M10 x 1.50	0.0 - 2.5	0.1	01M100CHB025X	13.0	13.0	16.0	31.5	20.0	1.5	13.0	5.5	4350	53	51	16.8	
	1.0 - 4.0	0.1	01M100CHB040X	13.0	13.0	16.0	33.3	21.5	1.5	13.0	7.0	4350	53	51	17.3	
	2.5 - 5.5	0.1	01M100CHB055X	13.0	13.0	16.0	34.3	23.0	1.5	13.0	8.5	4350	53	51	17.5	
	4.5 - 7.0	0.1	01M100CHB070X	13.0	13.0	16.0	35.8	25.0	1.5	13.0	10.0	4350	53	51	17.9	
M12 x 1.75	0.0 - 4.2	0.1	01M120CHB042X	16.0	16.0	20.0	36.0	23.4	1.7	16.0	8.1	6500	92	88	29.3	
	2.5 - 6.0	0.1	01M120CHB060X	16.0	16.0	20.0	38.8	26.2	1.7	16.0	9.9	6500	92	88	30.0	
	4.0 - 7.6	0.1	01M120CHB076X	16.0	16.0	20.0	40.4	27.5	1.7	16.0	11.5	6500	92	88	30.7	
	7.0 - 9.2	0.1	01M120CHB092X	16.0	16.0	20.0	41.2	28.4	1.7	16.0	13.1	6500	92	88	31.3	
M14 x 2.00	0.0 - 3.0	0.1	01M140CHB030X	18.0	18.0	23.0	41.3	27.3	2.0	18.0	7.3	7800	148	142	42.5	
	2.0 - 5.0	0.1	01M140CHB050X	18.0	18.0	23.0	43.3	29.3	2.0	18.0	9.3	7800	148	142	43.7	
	4.0 - 7.0	0.1	01M140CHB070X	18.0	18.0	23.0	45.5	31.5	2.0	18.0	11.3	7800	148	142	45.0	
	7.0 - 9.0	0.1	01M140CHB090X	18.0	18.0	23.0	47.6	33.6	2.0	18.0	13.3	7800	148	142	46.3	
M16 x 2.00	0.0 - 3.2	0.1	01M160CHB032X	21.0	21.0	26.0	44.3	28.5	2.5	21.0	8.4	10500	232	222	61.3	
	1.0 - 5.7	0.1	01M160CHB057X	21.0	21.0	26.0	46.8	31.0	2.5	21.0	10.9	10500	232	222	63.2	
	3.5 - 8.3	0.1	01M160CHB082X	21.0	21.0	26.0	49.3	33.5	2.5	21.0	13.4	10500	232	222	65.1	
	7.0 - 11.0	0.1	01M160CHB110X	21.0	21.0	26.0	52.1	36.0	2.5	21.0	16.2	10500	232	222	67.2	

Écrou à sertir en aveugle correspondant à l'ancienne désignation H ... CB ... INOX MOLYBDENE
 Blind Rivet Nuts corresponding to old designation H ... CB ... MOLYBDENUM STAINLESS STEEL





Écrous à sertir en aveugle Blind Rivet Nuts



Matière : Inox 316L Material : 316L Stainless Steel
 Tête : Fraisée Head : Countersunk
 Fût : Cylindrique Body : Round
 Extrémité du fût : Ouvert Body end : Open Shape

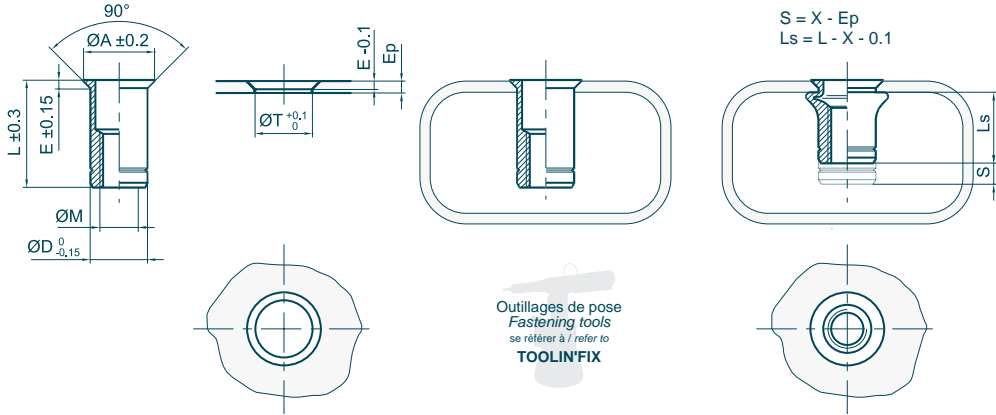

Ø M	Ep		Code	mm		Ø A	L	E	Ø D	X	daN	N,m	N,m	kg x1000
	min	max		ØT	ØA									
M2.5 x 0.45	1.0	1.7	01M025FRO017X	4.0	5.0	7.0	0.4	4.0	3.0	325	1.0	0.8	0.3	
M3 x 0.50	1.1	1.7	01M030FRO017X	5.0	6.8	7.3	1.0	5.0	2.9	500	1.4	1.0	0.6	
	1.1	2.3	01M030FRO023X	5.0	6.8	7.9	1.0	5.0	3.5	500	1.4	1.0	0.6	
	2.3	3.0	01M030FRO030X	5.0	6.8	8.5	1.0	5.0	4.1	500	1.4	1.0	0.6	
	1.1	2.1	01M040FRO021X	6.0	7.8	9.2	1.0	6.0	3.4	825	3.2	2.1	1.0	
M4 x 0.70	1.8	3.0	01M040FRO030X	6.0	7.8	10.1	1.0	6.0	4.3	825	3.2	2.1	1.0	
	2.5	3.7	01M040FRO037X	6.0	7.8	10.8	1.0	6.0	5.0	825	3.2	2.1	1.1	
	1.1	2.5	01M050FRO025X	7.0	8.8	10.6	1.0	7.0	4.1	1150	6.4	3.2	1.4	
	1.1	3.5	01M050FRO035X	7.0	8.8	11.6	1.0	7.0	5.1	1150	6.4	3.2	1.5	
M5 x 0.80	3.0	4.5	01M050FRO045X	7.0	8.8	12.6	1.0	7.0	6.1	1150	6.4	3.2	1.6	
	1.1	2.5	01M060FRO025X	9.0	10.8	12.9	1.0	9.0	4.5	1950	11.1	6.0	3.2	
	1.1	3.5	01M060FRO035X	9.0	10.8	13.9	1.0	9.0	5.5	1950	11.1	6.0	3.3	
	2.0	4.5	01M060FRO045X	9.0	10.8	14.9	1.0	9.0	6.5	1950	11.1	6.0	3.5	
M6 x 1.00	3.0	5.5	01M060FRO055X	9.0	10.8	15.9	1.0	9.0	7.5	1950	11.1	6.0	3.6	
	1.8	3.0	01M080FRO030X	11.0	13.8	15.6	1.5	11.0	5.2	3200	27	10.5	5.3	
	1.8	4.2	01M080FRO042X	11.0	13.8	16.8	1.5	11.0	6.4	3200	27	10.5	5.5	
	2.5	5.0	01M080FRO050X	11.0	13.8	17.6	1.5	11.0	7.2	3200	27	10.5	5.8	
M8 x 1.25	4.5	6.5	01M080FRO065X	11.0	13.8	18.8	1.5	11.0	8.7	3200	27	10.5	5.9	
	1.8	4.0	01M100FRO040X	13.0	15.8	19.9	1.5	13.0	7.0	4350	53	16.4	8.5	
	2.5	5.5	01M100FRO055X	13.0	15.8	21.4	1.5	13.0	8.5	4350	53	16.4	8.9	
	4.5	7.0	01M100FRO070X	13.0	15.8	22.9	1.5	13.0	10.0	4350	53	16.4	9.3	
M10 x 1.50	2.5	4.2	01M120FRO042X	16.0	19.8	23.5	2.0	16.0	8.1	6500	92	23.5	15.3	
	2.5	6.0	01M120FRO060X	16.0	19.8	25.3	2.0	16.0	9.9	6500	92	23.5	16.0	
	4.0	7.6	01M120FRO076X	16.0	19.8	26.8	2.0	16.0	11.5	6500	92	23.5	16.7	
	7.0	9.2	01M120FRO092X	16.0	19.8	28.4	2.0	16.0	13.1	6500	92	23.5	17.7	
M14 x 2.00	3.0	5.0	01M140FRO050X	18.0	22.8	26.7	2.5	18.0	9.3	7800	148	31.5	22.6	
	4.0	7.0	01M140FRO070X	18.0	22.8	28.7	2.5	18.0	11.3	7800	148	31.5	23.9	
	7.0	9.0	01M140FRO090X	18.0	22.8	30.7	2.5	18.0	13.3	7800	148	31.5	25.2	
M16 x 2.00	3.0	5.7	01M160FRO057X	21.0	25.8	28.0	2.5	21.0	10.9	10500	232	41	31.0	
	3.5	8.2	01M160FRO082X	21.0	25.8	30.5	2.5	21.0	13.4	10500	232	41	32.9	
	7.0	11.0	01M160FRO110X	21.0	25.8	33.3	2.5	21.0	16.2	10500	232	41	35.2	

Écrou à sertir en aveugle correspondant à l'ancienne désignation M ... FO ... INOX MOLYBDENE
 Blind Rivet Nuts corresponding to old designation M ... FO ... MOLYBDENUM STAINLESS STEEL



Écrous à sertir en aveugle Blind Rivet Nuts



Matière : Inox 316L Material : 316L Stainless Steel

Tête : Fraisée Head : Countersunk

Fût : Hexagonal Body : Hexagonal

Extrémité du fût : Ouvert Body end : Open Shape

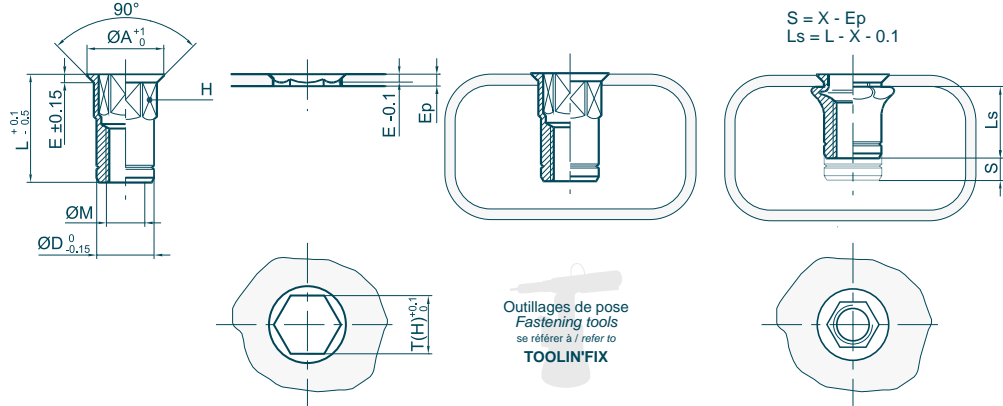

Ø M	Ep min - max	Code	H	mm T(H)	Ø A	L	E	Ø D	X indicative data	daN			kg x1000
										daN	N.m	N.m	
M2.5 x 0.45	1.0 - 1.7	01M025FHO017X	4.0	4.0	5.0	7.0	0.6	4.0	3.0	325	1.0	1.0	0.3
M3 x 0.50	1.1 - 1.7	01M030FHO017X	5.0	5.0	6.8	7.3	1.0	5.0	2.9	500	1.4	1.3	0.6
	1.1 - 2.3	01M030FHO023X	5.0	5.0	6.8	7.9	1.0	5.0	3.5	500	1.4	1.3	0.6
	2.3 - 3.0	01M030FHO030X	5.0	5.0	6.8	8.5	1.0	5.0	4.1	500	1.4	1.3	0.6
	1.1 - 2.1	01M040FHO021X	6.0	6.0	7.8	9.2	1.0	6.0	3.4	825	3.2	3.1	1.0
M4 x 0.70	1.8 - 3.0	01M040FHO030X	6.0	6.0	7.8	10.1	1.0	6.0	4.3	825	3.2	3.1	1.0
	2.5 - 3.7	01M040FHO037X	6.0	6.0	7.8	10.8	1.0	6.0	5.0	825	3.2	3.1	1.1
	1.1 - 2.5	01M050FHO025X	7.0	7.0	8.8	10.6	1.0	7.0	4.1	1150	6.4	6.1	1.4
	1.5 - 3.5	01M050FHO035X	7.0	7.0	8.8	11.6	1.0	7.0	5.1	1150	6.4	6.1	1.5
M5 x 0.80	3.0 - 4.5	01M050FHO045X	7.0	7.0	8.8	12.6	1.0	7.0	6.1	1150	6.4	6.1	1.6
	1.1 - 2.5	01M060FHO025X	9.0	9.0	10.8	12.9	1.0	9.0	4.5	1950	11.1	10.6	3.2
	1.5 - 3.5	01M060FHO035X	9.0	9.0	10.8	13.9	1.0	9.0	5.5	1950	11.1	10.6	3.3
	2.5 - 4.5	01M060FHO045X	9.0	9.0	10.8	14.9	1.0	9.0	6.5	1950	11.1	10.6	3.5
M6 x 1.00	3.5 - 5.5	01M060FHO055X	9.0	9.0	10.8	15.9	1.0	9.0	7.5	1950	11.1	10.6	3.6
	1.8 - 3.0	01M080FHO030X	11.0	11.0	13.8	15.6	1.5	11.0	5.2	3200	27	25.8	5.3
	2.2 - 4.2	01M080FHO042X	11.0	11.0	13.8	16.8	1.5	11.0	6.4	3200	27	25.8	5.5
	3.0 - 5.0	01M080FHO050X	11.0	11.0	13.8	17.6	1.5	11.0	7.2	3200	27	25.8	5.8
M8 x 1.25	4.5 - 6.5	01M080FHO065X	11.0	11.0	13.8	18.8	1.5	11.0	8.7	3200	27	25.8	5.9
	1.8 - 4.0	01M100FHO040X	13.0	13.0	15.8	19.9	1.5	13.0	7.0	4350	53	51	8.5
	2.5 - 5.5	01M100FHO055X	13.0	13.0	15.8	21.4	1.5	13.0	8.5	4350	53	51	8.9
	4.5 - 7.0	01M100FHO070X	13.0	13.0	15.8	22.9	1.5	13.0	10.0	4350	53	51	9.3
M10 x 1.50	2.5 - 4.2	01M120FHO042X	16.0	16.0	19.8	23.5	2.0	16.0	8.1	6500	92	88	15.3
	2.5 - 6.0	01M120FHO060X	16.0	16.0	19.8	25.3	2.0	16.0	9.9	6500	92	88	16.0
	4.0 - 7.6	01M120FHO076X	16.0	16.0	19.8	26.8	2.0	16.0	11.5	6500	92	88	16.7
	7.0 - 9.2	01M120FHO092X	16.0	16.0	19.8	28.4	2.0	16.0	13.1	6500	92	88	17.7
M14 x 2.00	3.0 - 5.0	01M140FHO050X	18.0	18.0	22.8	26.7	2.5	18.0	9.3	7800	148	142	22.6
	4.0 - 7.0	01M140FHO070X	18.0	18.0	22.8	28.7	2.5	18.0	11.3	7800	148	142	23.9
	7.0 - 9.0	01M140FHO090X	18.0	18.0	22.8	30.7	2.5	18.0	13.3	7800	148	142	25.2
M16 x 2.00	3.0 - 5.7	01M160FHO057X	21.0	21.0	25.8	28.0	2.5	21.0	10.9	10500	232	222	31.0
	3.5 - 8.2	01M160FHO082X	21.0	21.0	25.8	30.5	2.5	21.0	13.4	10500	232	222	32.9
	7.0 - 11.0	01M160FHO110X	21.0	21.0	25.8	33.3	2.5	21.0	16.2	10500	232	222	35.2

Écrou à sertir en aveugle correspondant à l'ancienne désignation H ... FO ... INOX MOLYBDENE
Blind Rivet Nuts corresponding to old designation H ... FO ... MOLYBDENUM STAINLESS STEEL

Catalog found by Google search and provided by: RIVET NUT USA™ RivetNutUSA.com | Sales@RivetNutUSA.com | 800.236.3200



Écrous à sertir en aveugle Blind Rivet Nuts



Matière : Inox 316L Material : 316L Stainless Steel
 Tête : Fraisée Head : Countersunk
 Fût : Cannelé Body : Knurled
 Extrémité du fût : Ouvert Body end : Open Shape

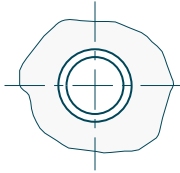
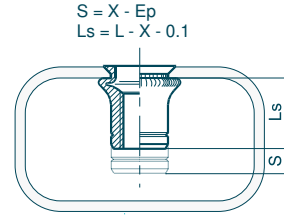
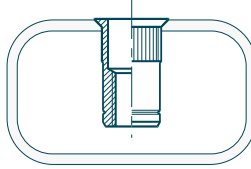
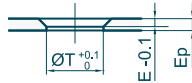
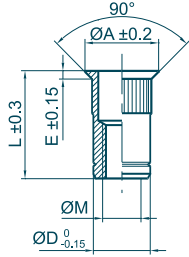

Outillages de pose
Fastening tools
se référer à / refer to
TOOLIN'FIX

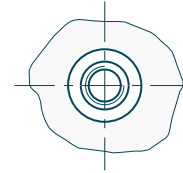

Ø M	Ep		Code	mm ØT	Ø A	L	E	Ø D	X indicative data		daN	N,m	N,m	kg x1000
	min	max												
M2.5 x 0.45	1.0	1.7	01M025FCO017X	4.0	5.0	7.0	0.6	4.0	3.0	325	1.0	0.8	0.3	
M3 x 0.50	1.1	1.7	01M030FCO017X	5.0	6.8	7.3	1.0	5.0	2.9	500	1.4	1.0	0.6	
	1.1	2.3	01M030FCO023X	5.0	6.8	7.9	1.0	5.0	3.5	500	1.4	1.0	0.6	
	2.3	3.0	01M030FCO030X	5.0	6.8	8.5	1.0	5.0	4.1	500	1.4	1.0	0.6	
	1.1	2.1	01M040FCO021X	6.0	7.8	9.2	1.0	6.0	3.4	825	3.2	2.1	1.0	
M4 x 0.70	1.8	3.0	01M040FCO030X	6.0	7.8	10.1	1.0	6.0	4.3	825	3.2	2.1	1.0	
	2.5	3.7	01M040FCO037X	6.0	7.8	10.8	1.0	6.0	5.0	825	3.2	2.1	1.1	
	1.1	2.5	01M050FCO025X	7.0	8.8	10.6	1.0	7.0	4.1	1150	6.4	3.2	1.4	
	1.5	3.5	01M050FCO035X	7.0	8.8	11.6	1.0	7.0	5.1	1150	6.4	3.2	1.5	
M5 x 0.80	3.0	4.5	01M050FCO045X	7.0	8.8	12.6	1.0	7.0	6.1	1150	6.4	3.2	1.6	
	1.1	2.5	01M060FCO025X	9.0	10.8	12.9	1.0	9.0	4.5	1950	11.1	6.0	3.2	
	1.5	3.5	01M060FCO035X	9.0	10.8	13.9	1.0	9.0	5.5	1950	11.1	6.0	3.3	
	2.5	4.5	01M060FCO045X	9.0	10.8	14.9	1.0	9.0	6.5	1950	11.1	6.0	3.5	
M6 x 1.00	3.5	5.5	01M060FCO055X	9.0	10.8	15.9	1.0	9.0	7.5	1950	11.1	6.0	3.6	
	1.8	3.0	01M080FCO030X	11.0	13.8	15.6	1.5	11.0	5.2	3200	27	10.5	5.3	
	2.2	4.2	01M080FCO042X	11.0	13.8	16.8	1.5	11.0	6.4	3200	27	10.5	5.5	
	3.0	5.0	01M080FCO050X	11.0	13.8	17.6	1.5	11.0	7.2	3200	27	10.5	5.8	
M8 x 1.25	4.5	6.5	01M080FCO065X	11.0	13.8	18.8	1.5	11.0	8.7	3200	27	10.5	5.9	
	1.8	4.0	01M100FCO040X	13.0	15.8	19.9	1.5	13.0	7.0	4350	53	16.4	8.5	
	2.5	5.5	01M100FCO055X	13.0	15.8	21.4	1.5	13.0	8.5	4350	53	16.4	8.9	
	4.5	7.0	01M100FCO070X	13.0	15.8	22.9	1.5	13.0	10.0	4350	53	16.4	9.3	
M10 x 1.50	2.5	4.2	01M120FCO042X	16.0	19.8	23.5	2.0	16.0	8.1	6500	92	23.5	15.3	
	2.5	6.0	01M120FCO060X	16.0	19.8	25.3	2.0	16.0	9.9	6500	92	23.5	16.0	
	4.0	7.6	01M120FCO076X	16.0	19.8	26.8	2.0	16.0	11.5	6500	92	23.5	16.7	
	7.0	9.2	01M120FCO092X	16.0	19.8	28.4	2.0	16.0	13.1	6500	92	23.5	17.7	
M14 x 2.00	3.0	5.0	01M140FCO050X	18.0	22.8	26.7	2.5	18.0	9.3	7800	148	31.5	22.6	
	4.0	7.0	01M140FCO070X	18.0	22.8	28.7	2.5	18.0	11.3	7800	148	31.5	23.9	
	7.0	9.0	01M140FCO090X	18.0	22.8	30.7	2.5	18.0	13.3	7800	148	31.5	25.2	
	3.0	5.7	01M160FCO057X	21.0	25.8	28.0	2.5	21.0	10.9	10500	232	41	31.0	
M16 x 2.00	3.5	8.2	01M160FCO082X	21.0	25.8	30.5	2.5	21.0	13.4	10500	232	41	32.9	
	7.0	11.0	01M160FCO110X	21.0	25.8	33.3	2.5	21.0	16.2	10500	232	41	35.2	

Écrou à sertir en aveugle correspondant à l'ancienne désignation C ... FO ... INOX MOLYBDENE
 Blind Rivet Nuts corresponding to old designation C ... FO ... MOLYBDENE STAINLESS STEEL

Catalog found by Google search and provided by: RIVET NUT USA™ RivetNutUSA.com | Sales@RivetNutUSA.com | 800.236.3200



Écrous à sertir en aveugle Blind Rivet Nuts



Matière : Inox 316L	Material : 316L Stainless Steel
Tête : Étanche	Head : Water tight
Fût : Cylindrique	Body : Round
Extrémité du fût : Borgne	Body end : Closed End
Option : Etylène Propylène	Option : Etylene Propylene

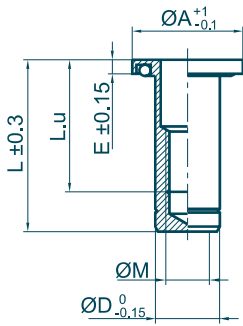

IP66 & IP67

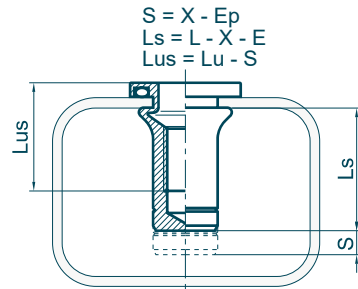
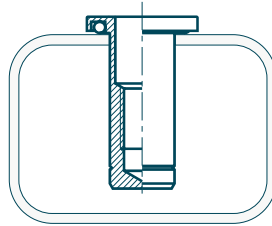
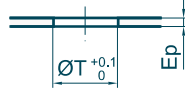

Outillages de pose
Fastening tools
se référer à / refer to
TOOLIN'FIX

Ø M	Ep min max	Code	mm ØT	Ø A	L	L.u	E	Ø D	X indicative data	daN	N.m	N.m	kg x1000
M3 x 0.50	0.0 - 1.1	17M030JRB011XEP	5.0	10.0	11.9	8.5	1.3	5.0	2.3	500	1.4	1.0	1.4
	0.0 - 1.7	17M030JRB017XEP	5.0	10.0	12.5	9.0	1.3	5.0	2.9	500	1.4	1.0	1.4
	1.0 - 2.3	17M030JRB023XEP	5.0	10.0	13.1	9.5	1.3	5.0	3.5	500	1.4	1.0	1.4
	2.3 - 3.0	17M030JRB030XEP	5.0	10.0	13.6	9.9	1.3	5.0	4.1	500	1.4	1.0	1.4
M4 x 0.70	0.0 - 1.3	17M040JRB013XEP	6.0	13.0	15.7	9.9	1.7	6.0	2.6	825	3.2	2.1	2.6
	0.8 - 2.1	17M040JRB021XEP	6.0	13.0	16.4	10.3	1.7	6.0	3.3	825	3.2	2.1	2.6
	1.8 - 3.0	17M040JRB030XEP	6.0	13.0	17.4	11.5	1.7	6.0	4.3	825	3.2	2.1	2.6
	2.5 - 3.7	17M040JRB037XEP	6.0	13.0	18.1	12.2	1.7	6.0	5.0	825	3.2	2.1	2.7
M5 x 0.80	0.0 - 1.5	17M050JRB015XEP	7.0	14.0	17.5	10.5	1.5	7.0	3.1	1150	6.4	3.2	3.6
	0.0 - 2.5	17M050JRB025XEP	7.0	14.0	18.5	11.5	1.5	7.0	4.1	1150	6.4	3.2	3.6
	1.0 - 3.5	17M050JRB035XEP	7.0	14.0	19.5	12.5	1.5	7.0	5.1	1150	6.4	3.2	3.7
	3.0 - 4.5	17M050JRB045XEP	7.0	14.0	20.5	13.5	1.5	7.0	6.1	1150	6.4	3.2	3.8
M6 x 1.00	0.0 - 1.5	17M060JRB015XEP	9.0	16.0	21.4	13.4	1.6	9.0	3.5	1950	11.1	6.0	7.1
	0.0 - 2.5	17M060JRB025XEP	9.0	16.0	22.4	14.0	1.6	9.0	4.5	1950	11.1	6.0	7.3
	1.0 - 3.5	17M060JRB035XEP	9.0	16.0	23.4	14.9	1.6	9.0	5.5	1950	11.1	6.0	7.4
	2.0 - 4.5	17M060JRB045XEP	9.0	16.0	24.3	15.8	1.6	9.0	6.5	1950	11.1	6.0	7.5
M8 x 1.25	0.0 - 1.8	17M080JRB018XEP	11.0	19.0	24.9	16.0	2.0	11.0	4.0	3200	27	10.5	11.5
	0.5 - 3.0	17M080JRB030XEP	11.0	19.0	26.1	17.8	2.0	11.0	5.2	3200	27	10.5	11.7
	1.8 - 4.2	17M080JRB042XEP	11.0	19.0	27.3	18.4	2.0	11.0	6.4	3200	27	10.5	12.0
	2.5 - 5.0	17M080JRB050XEP	11.0	19.0	28.1	19.2	2.0	11.0	7.2	3200	27	10.5	12.2
M10 x 1.50	4.5 - 6.5	17M080JRB065XEP	11.0	19.0	29.6	20.7	2.0	11.0	8.7	3200	27	10.5	12.5
	0.0 - 2.5	17M100JRB025XEP	13.0	21.0	32.0	20.5	2.0	13.0	5.5	4350	53	16.4	18.6
	1.0 - 4.0	17M100JRB040XEP	13.0	21.0	33.8	22.0	2.0	13.0	7.0	4350	53	16.4	19.1
	2.5 - 5.5	17M100JRB050XEP	13.0	21.0	34.8	23.5	2.0	13.0	8.5	4350	53	16.4	19.2
M12 x 1.75	4.5 - 7.0	17M100JRB070XEP	13.0	21.0	36.3	25.5	2.0	13.0	10.0	4350	53	16.4	19.5
	0.0 - 4.2	17M120JRB042XEP	16.0	26.0	37.1	24.5	2.8	16.0	8.1	6500	92	23.5	34.6
	2.5 - 6.0	17M120JRB060XEP	16.0	26.0	39.9	27.3	2.8	16.0	9.9	6500	92	23.5	35.4
	4.0 - 7.6	17M120JRB076XEP	16.0	26.0	41.5	28.6	2.8	16.0	11.5	6500	92	23.5	36.2
M14 x 2.00	7.0 - 9.2	17M120JRB092XEP	16.0	26.0	42.3	29.5	2.8	16.0	13.1	6500	92	23.5	36.8
	0.0 - 3.0	17M140JRB030XEP	18.0	30.0	42.6	28.6	3.3	18.0	7.3	7800	148	31.5	51.1
	2.0 - 5.0	17M140JRB050XEP	18.0	30.0	44.6	30.6	3.3	18.0	9.3	7800	148	31.5	52.3
	4.0 - 7.0	17M140JRB070XEP	18.0	30.0	46.8	32.8	3.3	18.0	11.3	7800	148	31.5	53.7
M16 x 2.00	7.0 - 9.0	17M140JRB090XEP	18.0	30.0	48.9	34.9	3.3	18.0	13.3	7800	148	31.5	55.0
	0.0 - 3.2	17M160JRB032XEP	21.0	35.0	45.5	29.7	3.7	21.0	8.4	10500	232	41	73.5
	1.0 - 5.7	17M160JRB057XEP	21.0	35.0	48.0	32.2	3.7	21.0	10.9	10500	232	41	75.2
	3.5 - 8.2	17M160JRB082XEP	21.0	35.0	50.5	34.7	3.7	21.0	13.4	10500	232	41	76.9
	7.0 - 11.0	17M160JRB110XEP	21.0	35.0	53.3	37.2	3.7	21.0	16.2	10500	232	41	79.0

Écrous à sertir en aveugle Blind Rivet Nuts



Matière : Aluminium

Material : Aluminium

Tête : Affleurante

Head : Flush

Fût : Cylindrique

Body : Round

Extrémité du fût : Ouvert

Body end : Open Shape

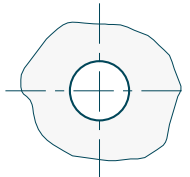
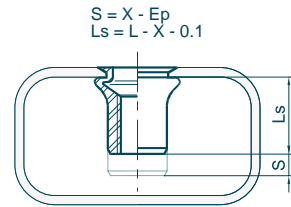
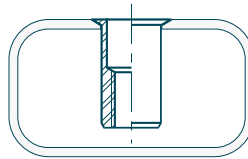
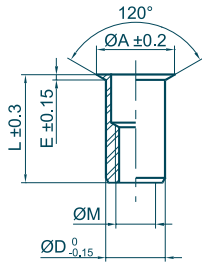

Outillages de pose
Fastening tools
se référer à / refer to
TOOLIN'FIX

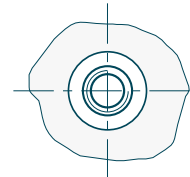

Ø M	Ep		Code	mm ØT	Ø A	L	E	Ø D	X	daN	N,m	N,m	kg x1000
	min	max											
M2.5 x 0.45	0.0 - 1.1	1.1	01U025ARO011X	4.0	4.6	6.4	0.3	4.0	2.4	165	0.6	0.6	0.1
	0.8 - 1.7	1.7	01U025ARO017X	4.0	4.6	7.0	0.3	4.0	3.0	165	0.6	0.6	0.1
M3 x 0.50	0.0 - 1.1	1.1	01U030ARO011X	5.0	5.8	7.2	0.3	5.0	2.4	225	0.8	0.8	0.2
	1.0 - 2.3	2.3	01U030ARO023X	5.0	5.8	8.6	0.3	5.0	3.6	225	0.8	0.8	0.2
	2.1 - 3.2	3.2	01U030ARO032X	5.0	5.8	9.7	0.3	5.0	4.7	225	0.8	0.8	0.2
	3.0 - 4.1	4.1	01U030ARO041X	5.0	5.8	10.6	0.3	5.0	5.6	225	0.8	0.8	0.2
M4 x 0.70	0.0 - 1.3	1.3	01U040ARO013X	6.0	6.8	9.4	0.3	6.0	2.6	400	1.9	1.9	0.3
	0.5 - 3.0	3.0	01U040ARO030X	6.0	6.8	11.1	0.3	6.0	4.3	400	1.9	1.9	0.4
	1.8 - 4.2	4.2	01U040ARO042X	6.0	6.8	12.3	0.3	6.0	5.5	400	1.9	1.9	0.4
	3.5 - 5.5	5.5	01U040ARO055X	6.0	6.8	13.5	0.3	6.0	6.8	400	1.9	1.9	0.4
M5 x 0.80	0.0 - 1.5	1.5	01U050ARO015X	7.0	8.0	10.8	0.4	7.0	3.0	650	3.8	3.2	0.5
	0.0 - 2.5	2.5	01U050ARO025X	7.0	8.0	11.8	0.4	7.0	4.0	650	3.8	3.2	0.5
	0.5 - 3.5	3.5	01U050ARO035X	7.0	8.0	12.8	0.4	7.0	5.0	650	3.8	3.2	0.6
	1.5 - 4.5	4.5	01U050ARO045X	7.0	8.0	13.8	0.4	7.0	6.0	650	3.8	3.2	0.6
M6 x 1.00	0.0 - 1.5	1.5	01U060ARO015X	9.0	10.0	13.3	0.4	9.0	3.4	1100	6.7	6.0	1.2
	1.0 - 3.5	3.5	01U060ARO035X	9.0	10.0	15.3	0.4	9.0	5.4	1100	6.7	6.0	1.3
	2.0 - 4.5	4.5	01U060ARO045X	9.0	10.0	16.3	0.4	9.0	6.4	1100	6.7	6.0	1.3
	3.0 - 5.5	5.5	01U060ARO055X	9.0	10.0	17.3	0.4	9.0	7.4	1100	6.7	6.0	1.4
M8 x 1.25	4.0 - 6.5	6.5	01U060ARO065X	9.0	10.0	18.3	0.4	9.0	8.4	1100	6.7	6.0	1.4
	0.0 - 1.8	1.8	01U080ARO018X	11.0	12.0	14.7	0.4	11.0	3.7	1750	16.2	10.5	1.7
	0.0 - 3.0	3.0	01U080ARO030X	11.0	12.0	15.9	0.4	11.0	4.9	1750	16.2	10.5	1.8
	1.3 - 4.2	4.2	01U080ARO042X	11.0	12.0	17.2	0.4	11.0	6.2	1750	16.2	10.5	1.9
M10 x 1.50	2.0 - 5.0	5.0	01U080ARO050X	11.0	12.0	17.8	0.4	11.0	6.9	1750	16.2	10.5	1.9
	3.5 - 6.5	6.5	01U080ARO065X	11.0	12.0	19.3	0.4	11.0	8.4	1750	16.2	10.5	2.0
	0.0 - 3.2	3.2	01U100ARO032X	13.0	14.5	20.6	0.6	13.0	6.0	2200	32	16.4	3.0
	2.0 - 5.5	5.5	01U100ARO055X	13.0	14.5	22.9	0.6	13.0	8.3	2200	32	16.4	3.2
M12 x 1.75	3.0 - 6.5	6.5	01U100ARO065X	13.0	14.5	23.9	0.6	13.0	9.3	2200	32	16.4	3.3
	4.5 - 7.5	7.5	01U100ARO075X	13.0	14.5	24.9	0.6	13.0	10.3	2200	32	16.4	3.4
	0.0 - 4.2	4.2	01U120ARO042X	16.0	17.5	24.3	0.6	16.0	7.3	3000	55	23.5	5.4
	2.0 - 6.0	6.0	01U120ARO060X	16.0	17.5	26.1	0.6	16.0	9.1	3000	55	23.5	5.7
M14 x 2.00	3.5 - 7.6	7.6	01U120ARO076X	16.0	17.5	27.7	0.6	16.0	10.7	3000	55	23.5	5.9
	6.0 - 9.2	9.2	01U120ARO092X	16.0	17.5	29.2	0.6	16.0	12.3	3000	55	23.5	6.1
	0.0 - 3.0	3.0	01U140ARO030X	18.0	19.5	26.6	0.6	18.0	7.0	3600	89	31.5	7.5
	1.0 - 5.0	5.0	01U140ARO050X	18.0	19.5	28.6	0.6	18.0	9.0	3600	89	31.5	8.0
M16 x 2.00	3.0 - 7.0	7.0	01U140ARO070X	18.0	19.5	30.6	0.6	18.0	11.0	3600	89	31.5	8.4
	6.0 - 9.0	9.0	01U140ARO090X	18.0	19.5	32.6	0.6	18.0	13.0	3600	89	31.5	8.8
	0.0 - 3.2	3.2	01U160ARO032X	21.0	22.5	28.0	0.6	21.0	8.2	5900	139	41	10.6
	0.0 - 5.7	5.7	01U160ARO057X	21.0	22.5	30.5	0.6	21.0	10.7	5900	139	41	11.2
M16 x 2.00	2.0 - 8.2	8.2	01U160ARO082X	21.0	22.5	32.9	0.6	21.0	13.2	5900	139	41	11.9
	6.0 - 11.0	11.0	01U160ARO110X	21.0	22.5	35.7	0.6	21.0	16.0	5900	139	41	12.6

Écrou à sertir en aveugle correspondant à l'ancienne désignation M ... FO ... ALUMINIUM

Blind Rivet Nuts corresponding to old designation M ... FO ... ALUMINIUM



Catalog found by Google search and provided by: **RIVET NUT USA™** RivetNutUSA.com | Sales@RivetNutUSA.com | 800.236.3200

LA CLUSIENNE-CLUFIX : Solutions et composants d'assemblage - Fastening solutions

313, rue Louis ARMAND - BP 220 - Z.I. des grands prés - 74304 Cluses Cedex France - Tel. +33 (0)4 50 98 13 13 - Fax. +33 (0)4 50 98 28 89 - www.lacrusienne.com

LA CLUSIENNE WARRANTS THAT THE PRODUCTS SOLD WILL BE FREE FROM DEFECTS IN MATERIAL AND WORKMANSHIP AND MEET THEIR APPLICABLE PRODUCT SPECIFICATIONS LA CLUSIENNE MAKES NO WARRANTY THAT THE PRODUCTS WILL BE MERCHANTABILITY OR FIT FOR ANY PARTICULAR PURPOSE.

2009.A



Écrous à sertir en aveugle Blind Rivet Nuts



Matière : Aluminium

Material : Aluminium

Tête : Affleurante

Head : Flush

Fût : Hexagonal

Body : Hexagonal

Extrémité du fût : Ouvert

Body end : Open Shape

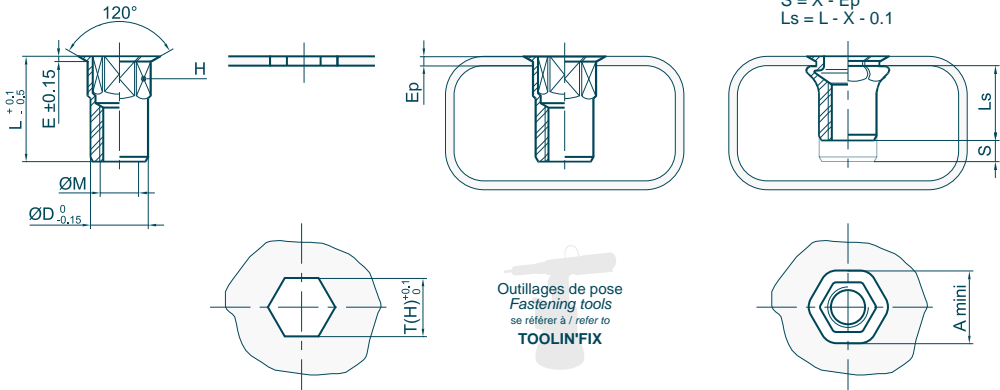

Ø M	Ep min - max	Code	H	mm T(H)	A	L	E	Ø D	X indicative data	daN			kg x1000
										daN	N,m	N,m	
M2.5 x 0.45	0.0 - 1.1	01U025AHO011X	4.0	4.0	4.6	6.4	0.3	4.0	2.4	165	0.6	0.6	0.1
	1.1 - 1.7	01U025AHO017X	4.0	4.0	4.6	7.0	0.3	4.0	3.0	165	0.6	0.6	0.1
M3 x 0.50	0.0 - 1.1	01U030AHO011X	5.0	5.0	5.8	7.2	0.3	5.0	2.4	225	0.8	0.8	0.2
	1.0 - 2.3	01U030AHO023X	5.0	5.0	5.8	8.6	0.3	5.0	3.6	225	0.8	0.8	0.2
	2.1 - 3.2	01U030AHO032X	5.0	5.0	5.8	9.7	0.3	5.0	4.7	225	0.8	0.8	0.2
	3.0 - 4.1	01U030AHO041X	5.0	5.0	5.8	10.6	0.3	5.0	5.6	225	0.8	0.8	0.2
M4 x 0.70	0.0 - 1.3	01U040AHO013X	6.0	6.0	6.8	9.4	0.3	6.0	2.6	400	1.9	1.8	0.3
	1.0 - 3.0	01U040AHO030X	6.0	6.0	6.8	11.1	0.3	6.0	4.3	400	1.9	1.8	0.4
	2.2 - 4.2	01U040AHO042X	6.0	6.0	6.8	12.3	0.3	6.0	5.5	400	1.9	1.8	0.4
	3.0 - 5.5	01U040AHO055X	6.0	6.0	6.8	13.5	0.3	6.0	6.8	400	1.9	1.8	0.4
M5 x 0.80	0.0 - 1.5	01U050AHO015X	7.0	7.0	8.0	10.8	0.4	7.0	3.0	650	3.8	3.7	0.5
	0.5 - 2.5	01U050AHO025X	7.0	7.0	8.0	11.8	0.4	7.0	4.0	650	3.8	3.7	0.5
	1.5 - 3.5	01U050AHO035X	7.0	7.0	8.0	12.8	0.4	7.0	5.0	650	3.8	3.7	0.6
	2.5 - 4.5	01U050AHO045X	7.0	7.0	8.0	13.8	0.4	7.0	6.0	650	3.8	3.7	0.6
M6 x 1.00	0.0 - 1.5	01U060AHO015X	9.0	9.0	10.0	13.3	0.4	9.0	3.4	1100	6.7	6.4	1.2
	1.5 - 3.5	01U060AHO035X	9.0	9.0	10.0	15.3	0.4	9.0	5.4	1100	6.7	6.4	1.3
	2.5 - 4.5	01U060AHO045X	9.0	9.0	10.0	16.3	0.4	9.0	6.4	1100	6.7	6.4	1.3
	3.5 - 5.5	01U060AHO055X	9.0	9.0	10.0	17.3	0.4	9.0	7.4	1100	6.7	6.4	1.4
M8 x 1.25	4.5 - 6.5	01U060AHO065X	9.0	9.0	10.0	18.3	0.4	9.0	8.4	1100	6.7	6.4	1.4
	0.0 - 1.8	01U080AHO018X	11.0	11.0	12.0	14.7	0.4	11.0	3.7	1750	16.2	15.5	1.7
	1.0 - 3.0	01U080AHO030X	11.0	11.0	12.0	15.9	0.4	11.0	4.9	1750	16.2	15.5	1.8
	2.3 - 4.2	01U080AHO042X	11.0	11.0	12.0	17.2	0.4	11.0	6.2	1750	16.2	15.5	1.9
M10 x 1.50	3.0 - 5.0	01U080AHO050X	11.0	11.0	12.0	17.8	0.4	11.0	6.9	1750	16.2	15.5	1.9
	4.5 - 6.5	01U080AHO065X	11.0	11.0	12.0	19.3	0.4	11.0	8.4	1750	16.2	15.5	2.0
	0.0 - 3.2	01U100AHO032X	13.0	13.0	14.5	20.6	0.6	13.0	6.0	2200	32	30.4	3.0
	2.0 - 5.5	01U100AHO055X	13.0	13.0	14.5	22.9	0.6	13.0	8.3	2200	32	30.4	3.2
M12 x 1.75	3.0 - 6.5	01U100AHO065X	13.0	13.0	14.5	23.9	0.6	13.0	9.3	2200	32	30.4	3.3
	4.5 - 7.5	01U100AHO075X	13.0	13.0	14.5	24.9	0.6	13.0	10.3	2200	32	30.4	3.4
	0.0 - 4.2	01U120AHO042X	16.0	16.0	17.5	24.3	0.6	16.0	7.3	3000	55	53	5.4
	2.0 - 6.0	01U120AHO060X	16.0	16.0	17.5	26.1	0.6	16.0	9.1	3000	55	53	5.7
M14 x 2.00	3.5 - 7.6	01U120AHO076X	16.0	16.0	17.5	27.7	0.6	16.0	10.7	3000	55	53	5.9
	6.0 - 9.2	01U120AHO092X	16.0	16.0	17.5	29.2	0.6	16.0	12.3	3000	55	53	6.1
	0.0 - 3.0	01U140AHO030X	18.0	18.0	19.5	26.6	0.6	18.0	7.0	3600	89	85	7.5
	1.0 - 5.0	01U140AHO050X	18.0	18.0	19.5	28.6	0.6	18.0	9.0	3600	89	85	8.0
M16 x 2.00	3.0 - 7.0	01U140AHO070X	18.0	18.0	19.5	30.6	0.6	18.0	11.0	3600	89	85	8.4
	6.0 - 9.0	01U140AHO090X	18.0	18.0	19.5	32.6	0.6	18.0	13.0	3600	89	85	8.8
	0.0 - 3.2	01U160AHO032X	21.0	21.0	22.5	28.0	0.6	21.0	8.2	5900	139	133	10.6
	0.0 - 5.7	01U160AHO057X	21.0	21.0	22.5	30.5	0.6	21.0	10.7	5900	139	133	11.2
M16 x 2.00	2.0 - 8.2	01U160AHO082X	21.0	21.0	22.5	32.9	0.6	21.0	13.2	5900	139	133	11.9
	6.0 - 11.0	01U160AHO110X	21.0	21.0	22.5	35.7	0.6	21.0	16.0	5900	139	133	12.6

Écrou à sertir en aveugle correspondant à l'ancienne désignation H ... fO ... ALUMINIUM
Blind Rivet Nuts corresponding to old designation H ... fO ... ALUMINIUM





Écrous à sertir en aveugle Blind Rivet Nuts



Matière : Aluminium	Material : Aluminium
Tête : Cylindrique	Head : Flange
Fût : Cylindrique	Body : Round
Extrémité du fût : Ouvert	Body end : Open Shape

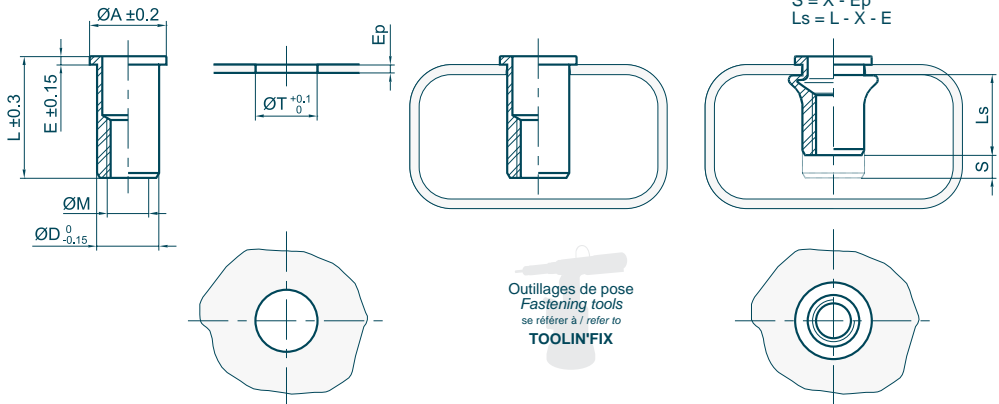

Ø M	Ep		Code	mm ØT	Ø A	L	E	Ø D	X indicative data				
	min	max											
M2.5 x 0.45	0.0 - 1.1	1.1	01U025CRO011X	4.0	6.0	6.9	0.6	4.0	2.4	165	0.6	0.6	0.1
	0.8 - 1.7	1.7	01U025CRO017X	4.0	6.0	7.5	0.6	4.0	3.0	165	0.6	0.6	0.1
M3 x 0.50	0.0 - 1.1	1.1	01U030CRO011X	5.0	7.0	7.9	0.8	5.0	2.2	225	0.8	0.8	0.2
	0.0 - 1.7	1.7	01U030CRO017X	5.0	7.0	8.5	0.8	5.0	2.8	225	0.8	0.8	0.2
	1.0 - 2.3	2.3	01U030CRO023X	5.0	7.0	9.1	0.8	5.0	3.4	225	0.8	0.8	0.3
	1.8 - 3.0	3.0	01U030CRO030X	5.0	7.0	9.7	0.8	5.0	4.0	225	0.8	0.8	0.3
M4 x 0.70	0.0 - 1.3	1.3	01U040CRO013X	6.0	8.0	10.1	0.8	6.0	2.6	400	1.9	1.9	0.4
	0.0 - 2.1	2.1	01U040CRO021X	6.0	8.0	10.9	0.8	6.0	3.4	400	1.9	1.9	0.4
	0.5 - 3.0	3.0	01U040CRO030X	6.0	8.0	11.9	0.8	6.0	4.3	400	1.9	1.9	0.4
	1.3 - 3.7	3.7	01U040CRO037X	6.0	8.0	12.5	0.8	6.0	5.0	400	1.9	1.9	0.4
M5 x 0.80	0.0 - 1.5	1.5	01U050CRO015X	7.0	9.0	11.7	1.0	7.0	3.0	650	3.8	3.2	0.6
	0.0 - 2.5	2.5	01U050CRO025X	7.0	9.0	12.7	1.0	7.0	4.0	650	3.8	3.2	0.6
	0.5 - 3.5	3.5	01U050CRO035X	7.0	9.0	13.7	1.0	7.0	5.0	650	3.8	3.2	0.6
	1.5 - 4.5	4.5	01U050CRO045X	7.0	9.0	14.7	1.0	7.0	6.0	650	3.8	3.2	0.7
M6 x 1.00	0.0 - 1.5	1.5	01U060CRO015X	9.0	11.0	14.4	1.2	9.0	3.4	1100	6.7	6.0	1.3
	0.0 - 2.5	2.5	01U060CRO025X	9.0	11.0	15.4	1.2	9.0	4.4	1100	6.7	6.0	1.4
	1.0 - 3.5	3.5	01U060CRO035X	9.0	11.0	16.4	1.2	9.0	5.4	1100	6.7	6.0	1.4
	2.0 - 4.5	4.5	01U060CRO045X	9.0	11.0	17.4	1.2	9.0	6.4	1100	6.7	6.0	1.5
M8 x 1.25	3.0 - 5.5	5.5	01U060CRO055X	9.0	11.0	18.4	1.2	9.0	7.4	1100	6.7	6.0	1.5
	0.0 - 1.8	1.8	01U080CRO018X	11.0	14.0	16.0	1.5	11.0	3.7	1750	16.2	10.5	2.0
	0.0 - 3.0	3.0	01U080CRO030X	11.0	14.0	17.3	1.5	11.0	4.9	1750	16.2	10.5	2.1
	1.2 - 4.2	4.2	01U080CRO042X	11.0	14.0	18.4	1.5	11.0	6.1	1750	16.2	10.5	2.2
M10 x 1.50	2.0 - 5.0	5.0	01U080CRO050X	11.0	14.0	19.5	1.5	11.0	6.9	1750	16.2	10.5	2.3
	3.5 - 6.5	6.5	01U080CRO065X	11.0	14.0	20.7	1.5	11.0	8.4	1750	16.2	10.5	2.4
	0.0 - 2.5	2.5	01U100CRO025X	13.0	16.0	21.3	1.5	13.0	5.3	2200	32	16.4	3.3
	0.5 - 4.0	4.0	01U100CRO040X	13.0	16.0	22.8	1.5	13.0	6.8	2200	32	16.4	3.5
M12 x 1.75	2.0 - 5.5	5.5	01U100CRO055X	13.0	16.0	24.5	1.5	13.0	8.3	2200	32	16.4	3.7
	4.0 - 7.0	7.0	01U100CRO070X	13.0	16.0	25.8	1.5	13.0	9.8	2200	32	16.4	3.8
	0.0 - 4.2	4.2	01U120CRO042X	16.0	20.0	25.9	1.7	16.0	7.3	3000	55	23.5	6.2
	2.0 - 6.0	6.0	01U120CRO060X	16.0	20.0	27.7	1.7	16.0	9.1	3000	55	23.5	6.4
M14 x 2.00	3.5 - 7.6	7.6	01U120CRO076X	16.0	20.0	29.3	1.7	16.0	10.7	3000	55	23.5	6.7
	6.0 - 9.2	9.2	01U120CRO092X	16.0	20.0	30.9	1.7	16.0	12.3	3000	55	23.5	6.9
	0.0 - 3.0	3.0	01U140CRO030X	18.0	23.0	28.6	2.0	18.0	7.0	3600	89	31.5	8.8
	1.0 - 5.0	5.0	01U140CRO050X	18.0	23.0	30.5	2.0	18.0	9.0	3600	89	31.5	9.2
M16 x 2.00	3.0 - 7.0	7.0	01U140CRO070X	18.0	23.0	32.5	2.0	18.0	11.0	3600	89	31.5	9.7
	6.0 - 9.0	9.0	01U140CRO090X	18.0	23.0	34.5	2.0	18.0	13.0	3600	89	31.5	10.1
	0.0 - 3.2	3.2	01U160CRO032X	21.0	26.0	30.3	2.5	21.0	8.2	5900	139	41	12.4
	0.0 - 5.7	5.7	01U160CRO057X	21.0	26.0	32.8	2.5	21.0	10.7	5900	139	41	13.1
M16 x 2.00	2.0 - 8.2	8.2	01U160CRO082X	21.0	26.0	35.3	2.5	21.0	13.2	5900	139	41	13.7
	6.0 - 11.0	11.0	01U160CRO110X	21.0	26.0	38.1	2.5	21.0	16.0	5900	139	41	14.5

Écrou à sertir en aveugle correspondant à l'ancienne désignation M ... CO ... ALUMINIUM
Blind Rivet Nuts corresponding to old designation M ... CO ... ALUMINIUM



Écrous à sertir en aveugle Blind Rivet Nuts



Matière : Aluminium

Material : Aluminium

Tête : Cylindrique

Head : Flange

Fût : Hexagonal

Body : Hexagonal

Extrémité du fût : Ouvert

Body end : Open Shape

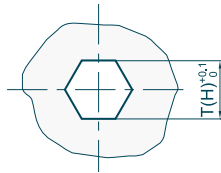
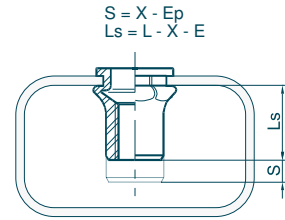
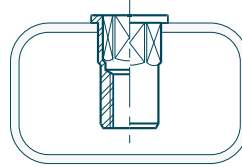
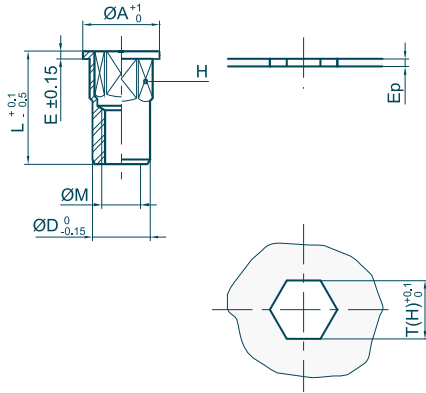

Outillages de pose
Fastening tools
se référer à / refer to
TOOLINFIX

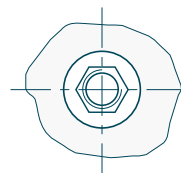

Ø M	Ep min - max	Code	H	mm T(H)	Ø A	L	E	Ø D	X indicative data	daN			kg x1000
										daN	N,m	N,m	
M2.5 x 0.45	0.0 - 1.1	01U025CHO011X	4.0	4.0	6.0	6.9	0.6	4.0	2.4	165	0.6	0.6	0.1
	1.1 - 1.7	01U025CHO017X	4.0	4.0	6.0	7.5	0.6	4.0	3.0	165	0.6	0.6	0.1
M3 x 0.50	0.0 - 1.1	01U030CHO011X	5.0	5.0	7.0	7.9	0.8	5.0	2.2	225	0.8	0.8	0.2
	0.0 - 1.7	01U030CHO017X	5.0	5.0	7.0	8.5	0.8	5.0	2.8	225	0.8	0.8	0.2
	1.0 - 2.3	01U030CHO023X	5.0	5.0	7.0	9.1	0.8	5.0	3.4	225	0.8	0.8	0.3
	1.8 - 3.0	01U030CHO030X	5.0	5.0	7.0	9.7	0.8	5.0	4.0	225	0.8	0.8	0.3
M4 x 0.70	0.0 - 1.3	01U040CHO013X	6.0	6.0	8.0	10.1	0.8	6.0	2.6	400	1.9	1.8	0.4
	0.0 - 2.1	01U040CHO021X	6.0	6.0	8.0	10.9	0.8	6.0	3.4	400	1.9	1.8	0.4
	1.0 - 3.0	01U040CHO030X	6.0	6.0	8.0	11.9	0.8	6.0	4.3	400	1.9	1.8	0.4
	1.7 - 3.7	01U040CHO037X	6.0	6.0	8.0	12.5	0.8	6.0	5.0	400	1.9	1.8	0.4
M5 x 0.80	0.0 - 1.5	01U050CHO015X	7.0	7.0	9.0	11.7	1.0	7.0	3.0	650	3.8	3.7	0.6
	0.0 - 2.5	01U050CHO025X	7.0	7.0	9.0	12.7	1.0	7.0	4.0	650	3.8	3.7	0.6
	1.5 - 3.5	01U050CHO035X	7.0	7.0	9.0	13.7	1.0	7.0	5.0	650	3.8	3.7	0.6
	2.5 - 4.5	01U050CHO045X	7.0	7.0	9.0	14.7	1.0	7.0	6.0	650	3.8	3.7	0.7
M6 x 1.00	0.0 - 1.5	01U060CHO015X	9.0	9.0	11.0	14.4	1.2	9.0	3.4	1100	6.7	6.4	1.3
	0.5 - 2.5	01U060CHO025X	9.0	9.0	11.0	15.4	1.2	9.0	4.4	1100	6.7	6.4	1.4
	1.5 - 3.5	01U060CHO035X	9.0	9.0	11.0	16.4	1.2	9.0	5.4	1100	6.7	6.4	1.4
	2.5 - 4.5	01U060CHO045X	9.0	9.0	11.0	17.4	1.2	9.0	6.4	1100	6.7	6.4	1.5
M8 x 1.25	3.5 - 5.5	01U060CHO055X	9.0	9.0	11.0	18.4	1.2	9.0	7.4	1100	6.7	6.4	1.5
	0.0 - 1.8	01U080CHO018X	11.0	11.0	14.0	16.0	1.5	11.0	3.7	1750	16.2	15.5	2.0
	1.0 - 3.0	01U080CHO030X	11.0	11.0	14.0	17.3	1.5	11.0	4.9	1750	16.2	15.5	2.1
	2.2 - 4.2	01U080CHO042X	11.0	11.0	14.0	18.4	1.5	11.0	6.1	1750	16.2	15.5	2.2
M10 x 1.50	3.0 - 5.0	01U080CHO050X	11.0	11.0	14.0	19.5	1.5	11.0	6.9	1750	16.2	15.5	2.3
	4.5 - 6.5	01U080CHO065X	11.0	11.0	14.0	20.7	1.5	11.0	8.4	1750	16.2	15.5	2.4
	0.0 - 2.5	01U100CHO025X	13.0	13.0	16.0	21.3	1.5	13.0	5.3	2200	32	30.4	3.3
	0.5 - 4.0	01U100CHO040X	13.0	13.0	16.0	22.8	1.5	13.0	6.8	2200	32	30.4	3.5
M12 x 1.75	2.0 - 5.5	01U100CHO055X	13.0	13.0	16.0	24.5	1.5	13.0	8.3	2200	32	30.4	3.7
	4.0 - 7.0	01U100CHO070X	13.0	13.0	16.0	25.8	1.5	13.0	9.8	2200	32	30.4	3.8
	0.0 - 4.2	01U120CHO042X	16.0	16.0	20.0	25.9	1.7	16.0	7.3	3000	55	53	6.2
	2.0 - 6.0	01U120CHO060X	16.0	16.0	20.0	27.7	1.7	16.0	9.1	3000	55	53	6.4
M14 x 2.00	3.5 - 7.6	01U120CHO076X	16.0	16.0	20.0	29.3	1.7	16.0	10.7	3000	55	53	6.7
	6.0 - 9.2	01U120CHO092X	16.0	16.0	20.0	30.9	1.7	16.0	12.3	3000	55	53	6.9
	0.0 - 3.0	01U140CHO030X	18.0	18.0	23.0	28.6	2.0	18.0	7.0	3600	89	85	8.8
	1.0 - 5.0	01U140CHO050X	18.0	18.0	23.0	30.5	2.0	18.0	9.0	3600	89	85	9.2
M16 x 2.00	3.0 - 7.0	01U140CHO070X	18.0	18.0	23.0	32.5	2.0	18.0	11.0	3600	89	85	9.7
	6.0 - 9.0	01U140CHO090X	18.0	18.0	23.0	34.5	2.0	18.0	13.0	3600	89	85	10.1
	0.0 - 3.2	01U160CHO032X	21.0	21.0	26.0	30.3	2.5	21.0	8.2	5900	139	133	12.4
	0.0 - 5.7	01U160CHO057X	21.0	21.0	26.0	32.8	2.5	21.0	10.7	5900	139	133	13.1
M16 x 2.00	2.0 - 8.2	01U160CHO082X	21.0	21.0	26.0	35.3	2.5	21.0	13.2	5900	139	133	13.7
	6.0 - 11.0	01U160CHO110X	21.0	21.0	26.0	38.1	2.5	21.0	16.0	5900	139	133	14.5

Écrou à sertir en aveugle correspondant à l'ancienne désignation H ... CO ... ALUMINIUM
Blind Rivet Nuts corresponding to old designation H ... CO ... ALUMINIUM



Écrous à sertir en aveugle Blind Rivet Nuts



Matière : Aluminium

Material : Aluminium

Tête : Fraisée

Head : Countersunk

Fût : Cylindrique

Body : Round

Extrémité du fût : Ouvert

Body end : Open Shape

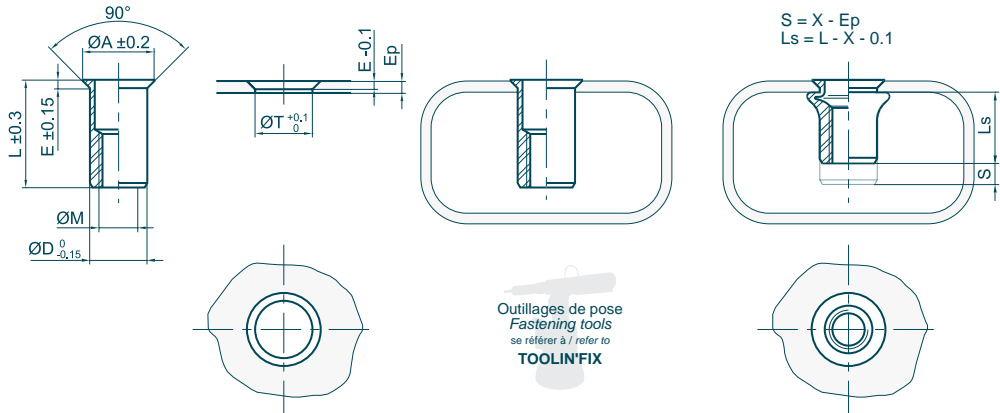

Outillages de pose
Fastening tools
se référer à / refer to
TOOLIN'FIX

Ø M	Ep		Code	mm ØT	Ø A	L	E	Ø D	X	daN	N,m	N,m	kg x1000
	min	max											
M2.5 x 0.45	0.8 - 1.7		01U025FRO017X	4.0	5.0	7.0	0.4	4.0	3.0	165	0.6	0.6	0.1
M3 x 0.50	1.1 - 1.7		01U030FRO017X	5.0	6.8	7.8	1.0	5.0	2.8	225	0.8	0.8	0.2
	1.1 - 2.3		01U030FRO023X	5.0	6.8	8.4	1.0	5.0	3.4	225	0.8	0.8	0.2
	1.8 - 3.0		01U030FRO030X	5.0	6.8	9.0	1.0	5.0	4.0	225	0.8	0.8	0.2
	1.1 - 2.1		01U040FRO021X	6.0	7.8	10.2	1.0	6.0	3.4	400	1.9	1.9	0.4
M4 x 0.70	1.1 - 3.0		01U040FRO030X	6.0	7.8	11.1	1.0	6.0	4.3	400	1.9	1.9	0.4
	1.3 - 3.7		01U040FRO037X	6.0	7.8	11.8	1.0	6.0	5.0	400	1.9	1.9	0.4
	1.1 - 2.5		01U050FRO025X	7.0	8.8	11.8	1.0	7.0	4.0	650	3.8	3.2	0.6
	1.1 - 3.5		01U050FRO035X	7.0	8.8	12.8	1.0	7.0	5.0	650	3.8	3.2	0.6
M5 x 0.80	1.5 - 4.5		01U050FRO045X	7.0	8.8	13.8	1.0	7.0	6.0	650	3.8	3.2	0.6
	1.1 - 2.5		01U060FRO025X	9.0	10.8	14.3	1.0	9.0	4.4	1100	6.7	6.0	1.2
	1.1 - 3.5		01U060FRO035X	9.0	10.8	15.3	1.0	9.0	5.4	1100	6.7	6.0	1.3
	2.0 - 4.5		01U060FRO045X	9.0	10.8	16.3	1.0	9.0	6.4	1100	6.7	6.0	1.3
M6 x 1.00	3.0 - 5.5		01U060FRO055X	9.0	10.8	17.3	1.0	9.0	7.4	1100	6.7	6.0	1.4
	1.8 - 3.0		01U080FRO030X	11.0	13.8	15.8	1.5	11.0	4.9	1750	16.2	10.5	1.9
	1.8 - 4.2		01U080FRO042X	11.0	13.8	17.0	1.5	11.0	6.1	1750	16.2	10.5	2.0
	2.0 - 5.0		01U080FRO050X	11.0	13.8	17.8	1.5	11.0	6.9	1750	16.2	10.5	2.0
M8 x 1.25	3.5 - 6.5		01U080FRO065X	11.0	13.8	19.3	1.5	11.0	8.4	1750	16.2	10.5	2.1
	1.8 - 4.0		01U100FRO040X	13.0	15.8	21.4	1.5	13.0	6.8	2200	32	16.4	3.2
	2.0 - 5.5		01U100FRO055X	13.0	15.8	22.9	1.5	13.0	8.3	2200	32	16.4	3.3
	4.0 - 7.0		01U100FRO070X	13.0	15.8	24.4	1.5	13.0	9.8	2200	32	16.4	3.5
M10 x 1.50	2.5 - 4.2		01U120FRO042X	16.0	19.8	24.3	2.0	16.0	7.3	3000	55	23.5	5.7
	2.0 - 6.0		01U120FRO060X	16.0	19.8	26.1	2.0	16.0	9.1	3000	55	23.5	6.0
	3.5 - 7.6		01U120FRO076X	16.0	19.8	27.7	2.0	16.0	10.7	3000	55	23.5	6.2
	6.0 - 9.2		01U120FRO092X	16.0	19.8	29.3	2.0	16.0	12.3	3000	55	23.5	6.4
M12 x 1.75	1.0 - 5.0		01U140FRO050X	18.0	22.8	28.7	2.5	18.0	9.0	3600	89	31.5	8.4
	3.0 - 7.0		01U140FRO070X	18.0	22.8	30.6	2.5	18.0	11.0	3600	89	31.5	8.9
	6.0 - 9.0		01U140FRO090X	18.0	22.8	32.6	2.5	18.0	13.0	3600	89	31.5	9.3
	3.0 - 5.7		01U160FRO057X	21.0	25.8	30.4	2.5	21.0	10.7	5900	139	41	11.8
M16 x 2.00	2.0 - 8.2		01U160FRO082X	21.0	25.8	32.9	2.5	21.0	13.2	5900	139	41	12.4
	6.0 - 11.0		01U160FRO110X	21.0	25.8	35.7	2.5	21.0	16.0	5900	139	41	13.1

Écrou à sertir en aveugle correspondant à l'ancienne désignation M ... FO ... ALUMINIUM
Blind Rivet Nuts corresponding to old designation M ... FO ... ALUMINIUM

The **CLUFIX® rivet nut** is a branded product line made by LeankCo. **Rivet Nut USA™**, a division of Cardinal Components, Inc., is not a direct CLUFIX® distributor, but we can source and quote CLUFIX® products through a third-party.

Send us your CLUFIX® part number and we can assist!

Catalog found by Google search and provided by:

RIVET NUT USA™ | ISO 9001 CERTIFIED
RivetNutUSA.com | Sales@RivetNutUSA.com 800.236.3200